



UHF SERIES

UHF-601 · UHF-602 · UHF-604

WIRELESS MICROPHONE SYSTEM

Bedienungsanleitung
User Manual

Contents

1	Introduction	25
2	Safety Instructions	26
3	Product Overview Receiver	27
4	Setting Menu Receiver	30
4.1	Display setting menu.....	30
4.2	Functions.....	30
4.3	Switching on.....	31
4.4	Adjusting the channel group	32
4.5	Adjusting the transmission channel.....	33
4.6	Adjusting the equalizer.....	34
4.7	Automatic frequency setup	35
4.8	Adjusting a user color	36
4.9	ID verification	37
4.10	Enabling lock mode.....	38
4.11	Settings in the transmitter menu	39
5	Receiver Installation	40
5.1	Placing the receiver	40
5.2	Connecting the antennas	40
5.3	Rack mounting	40
5.4	Connecting an amplifier or mixing console.....	41
5.5	Connecting the power adapter.....	41
6	Receiver Operation	42
6.1	Establishing a radio link	42
6.2	Synchronizing devices	43
6.3	Adjusting the level.....	43
7	Product Overview Transmitters ..	44
8	Problem Chart	45
9	Technical Specifications	46
9.1	Item numbers	46
9.2	Radio frequencies	47



www.omnitronic.de

For product updates, documentation, software and support please visit www.omnitronic.de. You can find the latest version of this user manual in the product's download section. © 2025 OMNITRONIC. All rights reserved. No part of this document may be reproduced in any form without the written permission of the copyright owner. The contents of this document are subject to revision without notice due to continued progress in methodology, design, and manufacturing. All trademarks mentioned herein are the property of their respective owners. D00160520, version 1.0, publ. 16/01/2025

1 Introduction

The wireless microphone systems of the 600 series are reliable UHF PLL systems for everyday use. The units are available with different frequency bands and work with 120 channel presets. True diversity receiver technology and pilot tone make for a reliable transmission. Setup is quick and easy using auto-scan and infrared sync. TFT color displays provide a clear overview and a 7-band EQ allows for sound tuning.

This user manual will show you how to install and operate the wireless microphone system. Users of this product are recommended to carefully read all warnings in this manual and on the unit in order to protect yourself and others from damage.

Please save this document for future needs and pass it on to further owners.

1.1 Package contents

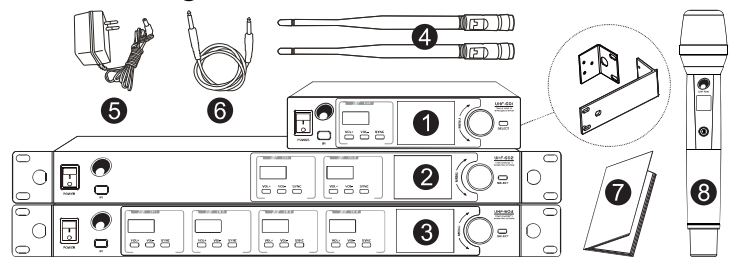

- ❶ UHF-601 receiver with 1 microphone & rack brackets
- ❷ UHF-602 receiver with 2 microphones
- ❸ UHF-604 receiver with 4 microphones
- ❹ Rod antennas (2)
- ❺ Power adapter
- ❻ Audio cable
- ❼ these instructions
- ❽ Microphone

1.2 Accessories

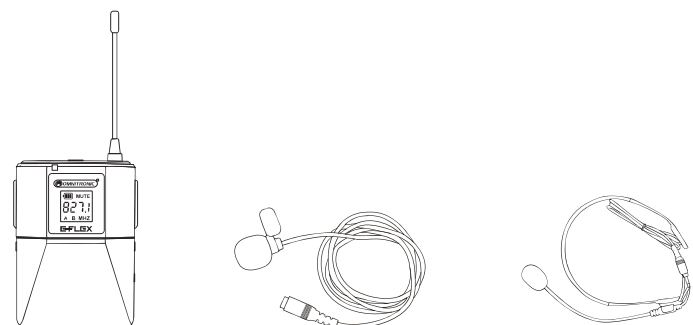

Bodypack

Lavalier microphone

Headset

823-832 und 863-865 MHz



CZ, FR, GB, HR,
LT, LV, PL, RO

2 Safety Instructions



- Please read these operating instructions carefully before using the product. They contain important information for the correct use of your product. Please keep them for future reference.
- The wireless microphone systems of the UHF-600 series consist of dynamic hand-held microphones with integrated transmitter which serve for wireless signal transmission to the receiving unit. The devices are available with 1, 2 and 4 channels and different transmission frequency bands. The transmission range is approx. 60 m and depends on the local conditions. Matching bodypack transmitters are available as accessories.
- This device utilizes frequencies that are not harmonized within the European Union (EU) and therefore is subject to restrictions in certain EU member states. Further information is enclosed with the product.
- Prior to use, make sure that the desired frequencies are approved and legal in your country and check whether the operation must be reported to the appropriate authority. Consult your national authority for possible requirements.
- Only use the product according to the instructions given herein, to avoid accidental injury or damage.
- We do not assume any liability for material and personal damage caused by improper use or non-compliance with these operating instructions. In such cases, the warranty/guarantee will be null and void.
- Unauthorized rebuilds or modifications of the product are not permitted for reasons of safety and render the warranty invalid.
- To reduce the risk of electric shock, do not open any part of the product. Only connect the product to a proper wall socket that complies with the product specification voltage. The mains outlet must be easily accessible so that you can unplug the device quickly if need be. Run the mains cable in such a way that it cannot be tripped over.
- This product is intended for indoor use only. Protect it from extreme temperatures, direct sunlight, strong jolts, high humidity, moisture, flammable gases, vapors and solvents. The recommended temperature range is -5 to +45 °C.
- Do not touch the power cord and connectors with wet hands as it may cause electric shock.
- Cleaning of the product is limited to the surface. Make sure that moisture does not come into contact with any areas of the terminal connections or mains voltage control parts. Only wipe off the product with a dry, lint-free cloth. Before cleaning, disconnect the product from the mains.
- If this product is no longer working properly or is visibly damaged, take it out of operation and consult your local dealer. Do not attempt to repair the product yourself.
- Handle the product with care; it can be damaged by impacts, blows, or accidental falls, even from a low height.
- This product is not a toy. Keep it out of the reach of children and pets. Do not leave packaging material lying around carelessly.
- Do not try to short-circuit, recharge, disassemble or heat batteries (danger of explosion!). Remove the batteries if the device is not used for a longer period of time. Damaged/leaking batteries may cause harm to your skin—use safety gloves.

Disposal of old equipment



When to be definitively put out of operation, take the product to a local recycling plant for a disposal which is not harmful to the environment. Devices marked with this symbol must not be disposed of as household waste. Contact your retailer or local authorities for more information.



Remove any inserted batteries and dispose of them separately from the product.



You as the end user are required by law (Battery Ordinance) to return all used batteries/rechargeable batteries. Disposing of them in the household waste is prohibited. You may return your used batteries free of charge to collection points in your municipality and anywhere where batteries/ rechargeable batteries are sold. By disposing of used devices and batteries correctly, you contribute to the protection of the environment.

3 Product Overview Receiver

3.1 UHF-601 Receiver

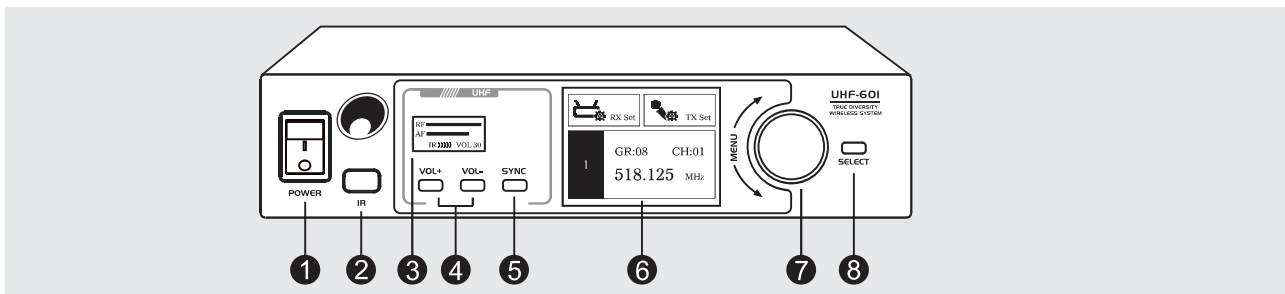

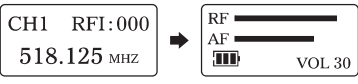
No.	Element	Function
1	Power switch	Switches the receiver on and off.
2	Infrared interface	To synchronize the receiver and transmitter, keep the IR interfaces at a maximum distance of 30 cm from each other.
3	Color display receiver unit 	The standard display shows the channel, frequency and RFI value (radio frequency interference). After synchronizing with the transmitter, the display shows the RF radio signal level, AF audio level, battery status and volume setting.
4	VOL-/VOL+ button	For setting the volume for the output signal of the receiver unit.
5	SYNC button	For synchronization with the transmitter.
6	Color display setting menu	Indicates all functions of the unit and information of the transmitter. The display icons will be explained in section 4.1 Display.
7	MENU knob	For adjusting values and navigating functions.
8	SELECT button	For calling the setting menu and navigating functions.

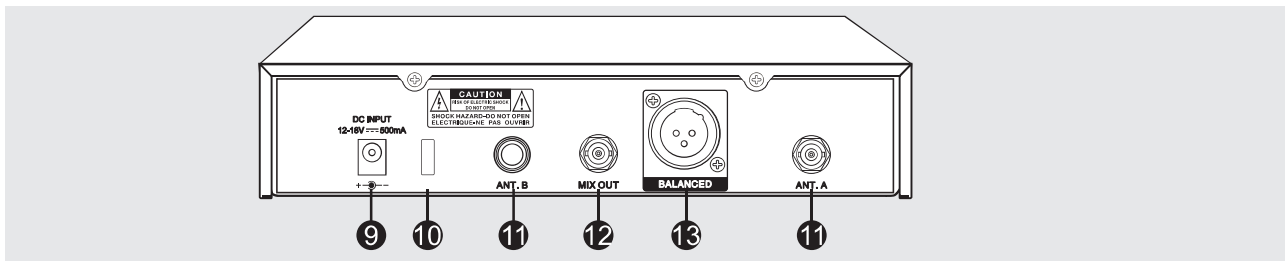

No.	Element	Function
9	Power input	Plug in the connection cable of the supplied power adapter here.
10	Cable grip	For the power cable.
11	Antenna inputs	To connect the antennas provided.
12	Signal output	Unbalanced 6.3 mm jack for connection to a microphone input of a mixer or amplifier.
13	Signal output	Balanced XLR output for connection to a microphone input of a mixer or amplifier.

3.2 UHF-602 Receiver

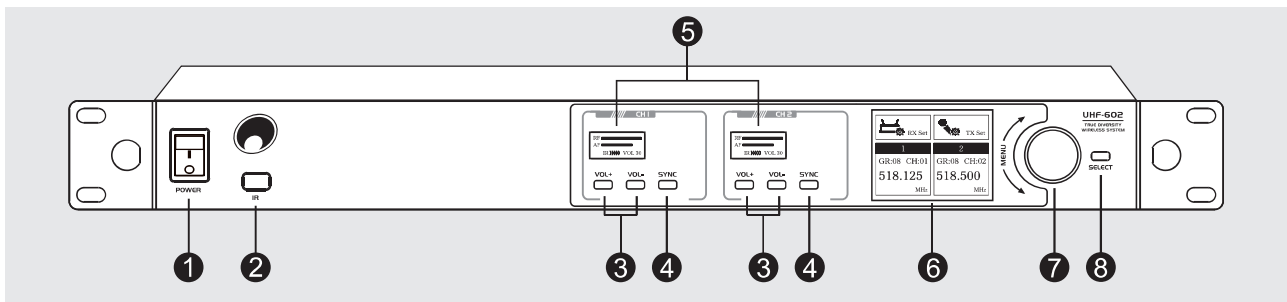

No.	Element	Function
1	Power switch	Switches the receiver on and off.
2	Infrared interface	To synchronize the receiver and transmitter, keep the IR interfaces at a maximum distance of 30 cm from each other.
3	VOL-/VOL+ button	For setting the volume for the output signal of the receiver unit.
4	SYNC button	For synchronization with the transmitter.
5	Color display receiver unit	The standard display shows the channel, frequency and RFI value (radio frequency interference). After synchronizing with the transmitter, the display shows the RF radio signal level, AF audio level, battery status and volume setting.
6	Color display setting menu	Indicates all functions of the unit and information of the transmitters. The display icons will be explained in section 4.1 Display.
7	MENU knob	For adjusting values and navigating functions.
8	SELECT button	For calling the setting menu and navigating functions.

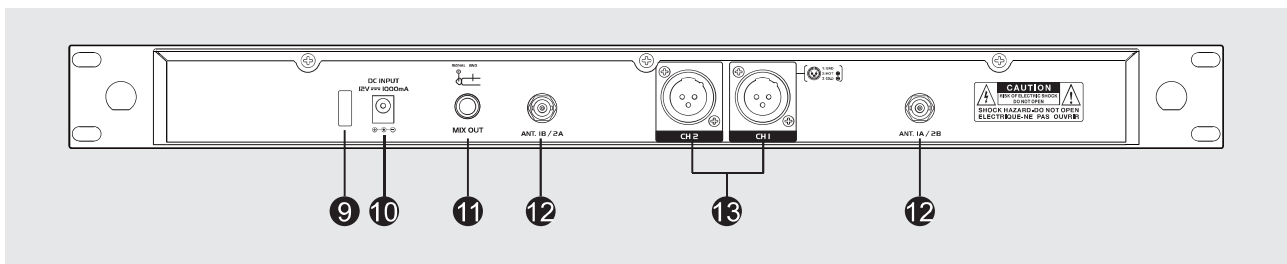

No.	Element	Function
9	Cable grip	For the power cable.
10	Power input	Plug in the connection cable of the supplied power adapter here.
11	Mixed output	Unbalanced 6.3 mm jack for the output of the master signal of both channels. For connection to microphone inputs of a mixer or amplifier.
12	Antenna inputs	To connect the antennas provided.
13	Channel outputs	Balanced XLR outputs for the output signal from the respective channel. For connection to balanced microphone inputs of a mixer or amplifier.

3.3 UHF-604 Receiver

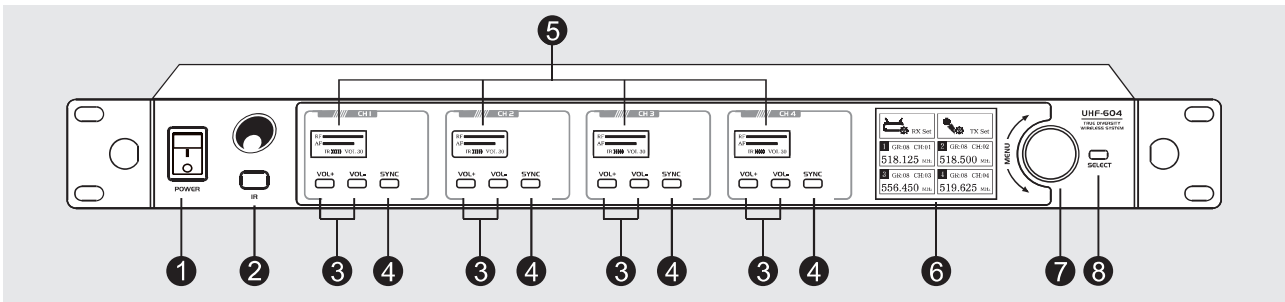

No.	Element	Function
1	Power switch	Switches the receiver on and off.
2	Infrared interface	To synchronize the receiver and transmitter, keep the IR interfaces at a maximum distance of 30 cm from each other.
3	VOL-/VOL+ button	For setting the volume for the output signal of the receiver unit.
4	SYNC button	For synchronization with the transmitter.
5	Color display receiver unit	The standard display shows the channel, frequency and RFI value (radio frequency interference). After synchronizing with the transmitter, the display shows the RF radio signal level, AF audio level, battery status and volume setting.
6	Color display setting menu	Indicates all functions of the unit and information of the transmitters. The display icons will be explained in section 4.1 Display.
7	MENU knob	For adjusting values and navigating functions.
8	SELECT button	For calling the setting menu and navigating functions.

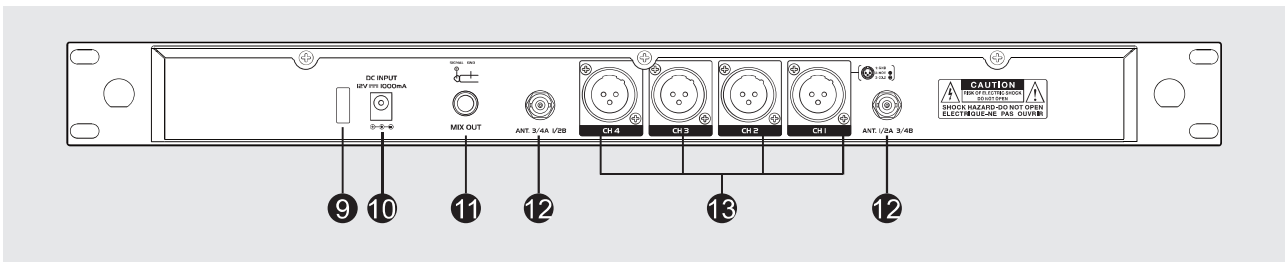

No.	Element	Function
9	Cable grip	For the power cable.
10	Power input	Plug in the connection cable of the supplied power adapter here.
11	Mixed output	Unbalanced 6.3 mm jack for the output of the master signal of all channels. For connection to microphone inputs of a mixer or amplifier.
12	Antenna inputs	To connect the antennas provided.
13	Channel outputs	Balanced XLR outputs for the output signal from the respective channel. For connection to balanced microphone inputs of a mixer or amplifier.

4 Setting Menu Receiver

4.1 Display setting menu

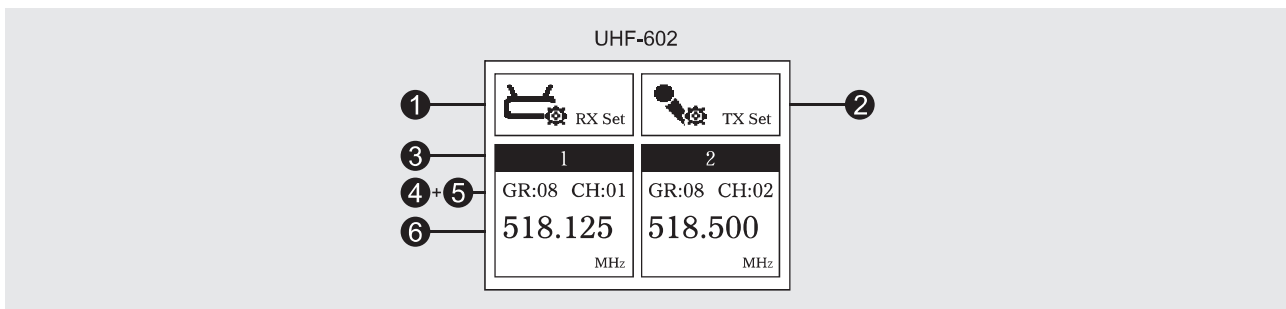

No.	Element
1	Receiver menu
2	Transmitter menu
3	Receiver channel
4	Group
5	Transmission channel
6	Transmission frequency

4.2 Functions

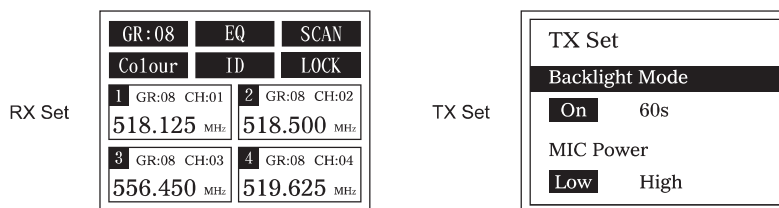

Indication	Function
GR	Adjusts the group (1-10)
CH	Adjusts the transmission channel (1-12)
EQ	Adjusts the 7-band equalizer (+12 dB to -12 dB)
SCAN	Automatic frequency setup
Colour	Adjusts a user color (6 colors available)
ID	Enables/disables ID verification
LOCK	Enables/disables lock mode
Backlight Mode	Adjusts the transmitter's display lighting (always on or 60 seconds on)
MIC Power	Adjusts the transmitter's transmission power (low or high)

- ▶ Call the receiver menu "RX Set" or transmitter menu "TX Set" with the SELECT button. Then press the control knob to call the menu items.
- ▶ In the receiver menu, use the SELECT button to navigate through the menu and briefly press the control knob to select a function for editing. Turn the control knob to make your settings (transmitter menu → Section 4.11). Any settings changed will be instantly accepted by the unit.
- ▶ The settings are transferred to the transmitters during synchronization. This allows you to configure all important settings for the transmitters from the receiver.
- ▶ Use the SELECT button to jump to the next higher menu level and exit the setting mode. The standard display will be indicated. If no button has been pressed for a few seconds, the setting mode will be exited automatically.

4.3 Switching on

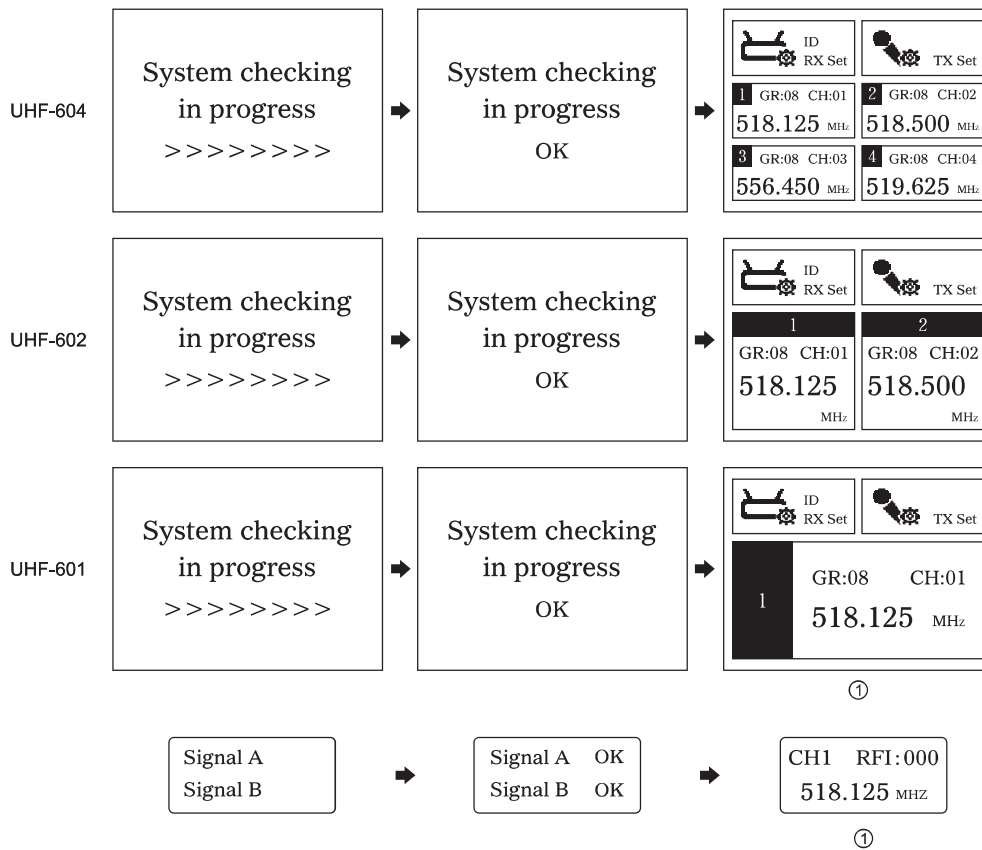

- ▶ Press the power switch to switch on. The displays light up.
- ▶ The device performs a short test on the receiver units and is then ready for operation. The displays for the setting menu and the receiver units then show the standard display (Fig. 1).

4.4 Adjusting the channel group

There are 120 channels available for radio transmission, which are divided into 10 groups for easy setup. Each group contains factory-preset, non-variable channels. The corresponding frequencies are shown in the table on page 47. Select the group here.

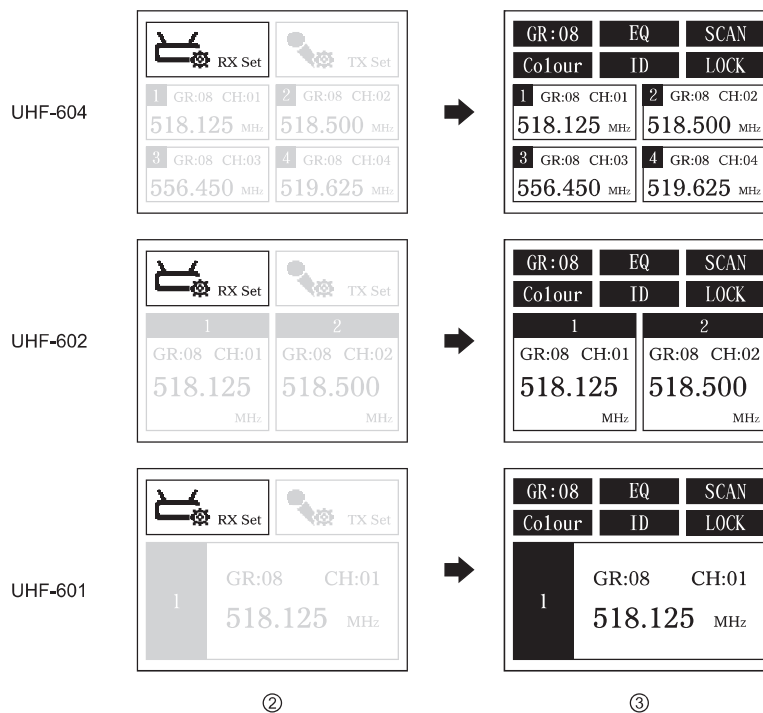

- ▶ Call the receiver menu "RX Set" with the SELECT button (Fig. 2).
- ▶ Then press the control knob to call the menu items (Fig. 3).



- ▶ Press the control knob to select the "GR" menu item (Fig. 4).
- ▶ Turn the control knob to select one of the groups (Fig. 5).
- ▶ Then set the transmission channel (→Section 4.5).

4.5 Adjusting the transmission channel

Select one of the factory default transmission channels within the current group. These transmission channels are free of intermodulation. For the operation of several radio links simultaneously, you should therefore select the channels from the same group.

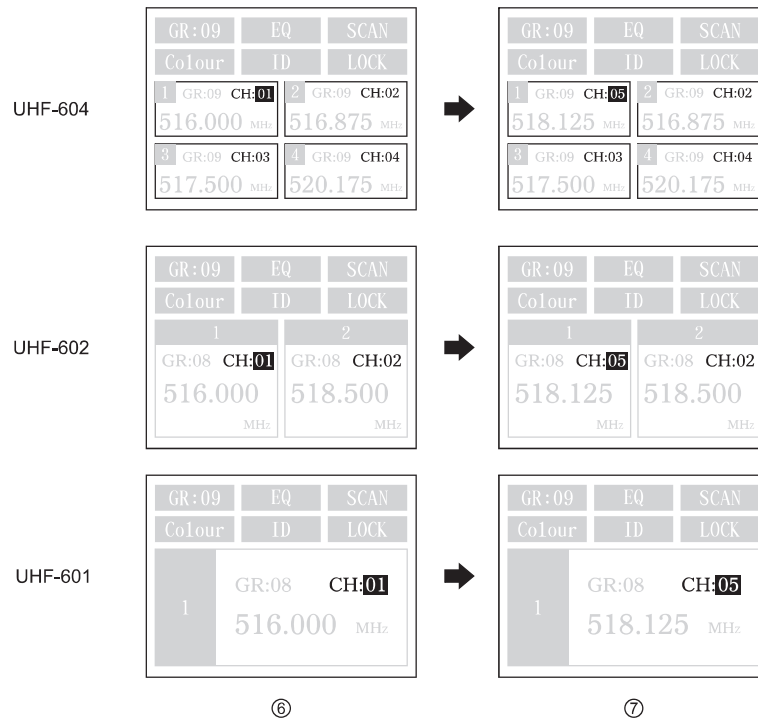

- ▶ After setting the channel group, press the control knob to select the “CH” menu item (Fig. 6). The current setting can now be changed.
- ▶ Turn the control knob and select one of the channels (Fig. 7).
- ▶ Press the control knob again and set the other channels in the same way or exit the setting mode with the SELECT button.

4.6 Adjusting the equalizer

A 7-band equalizer is available in this menu to adjust the sound within the range from +12 dB to -12 dB.

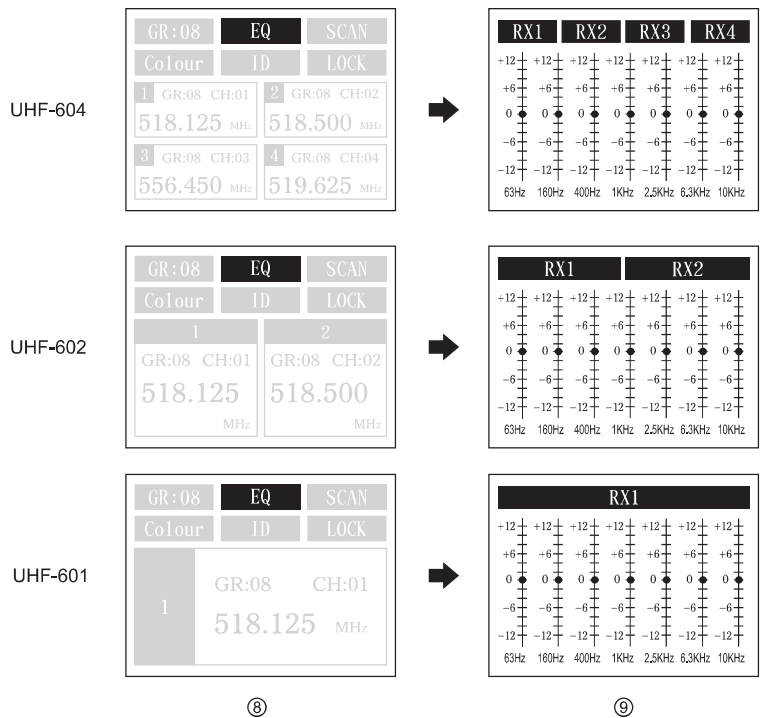

- ▶ In the receiver menu “RX Set”, use the SELECT button and the control knob to select the “EQ” menu item (Fig. 8 and 9).

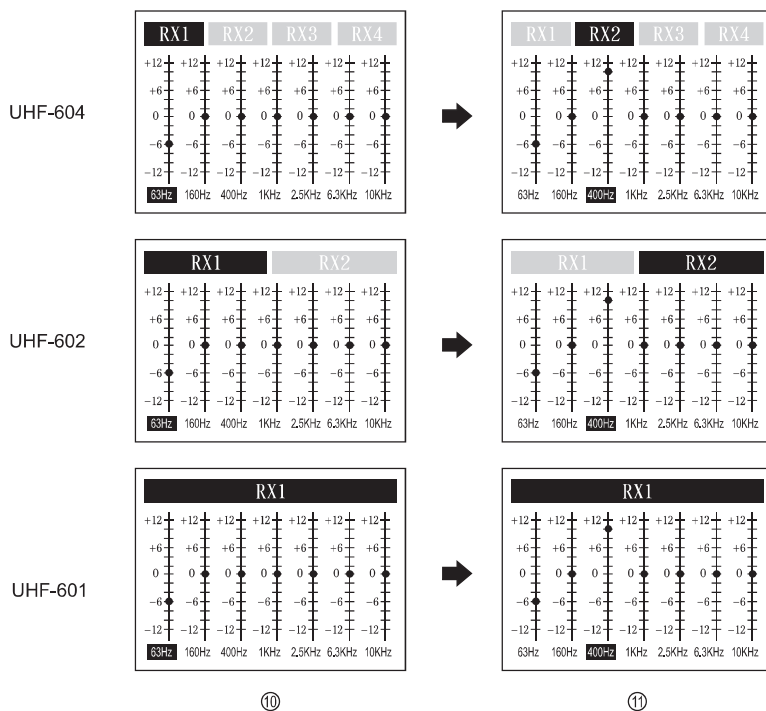

- ▶ Press the SELECT button to select the desired receiver channel RX1/2/3/4 (Fig. 10).
- ▶ Press the control knob to select a band, then turn it to edit it (Fig. 11).
- ▶ Press the SELECT button to exit the setting mode.

4.7 Automatic frequency setup

With the automatic scan feature you can set an interference-free transmission frequency. Leave transmitters that have already been set to a radio frequency switched on before performing the scan.

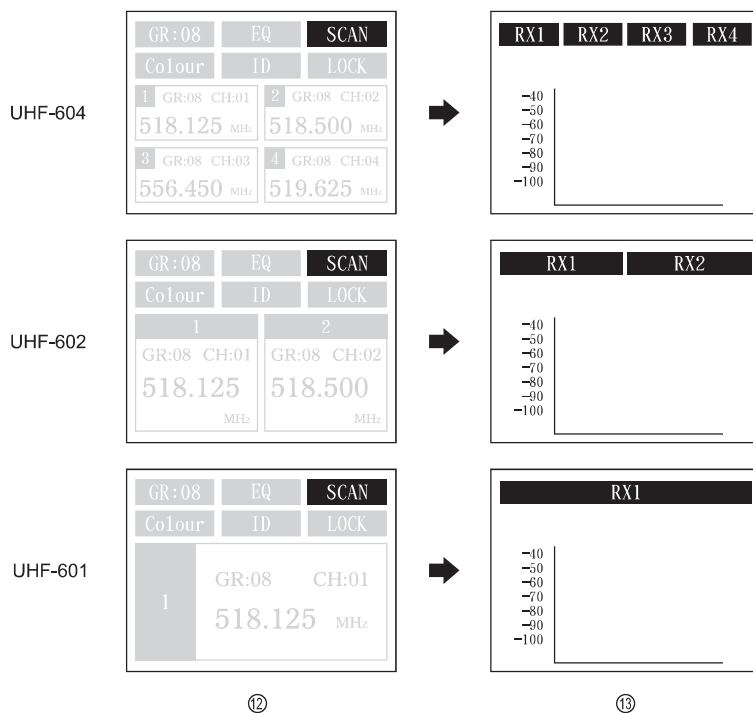

- ▶ In the receiver menu “RX Set”, use the SELECT button and the control knob to select the “SCAN” menu item (Fig. 12).

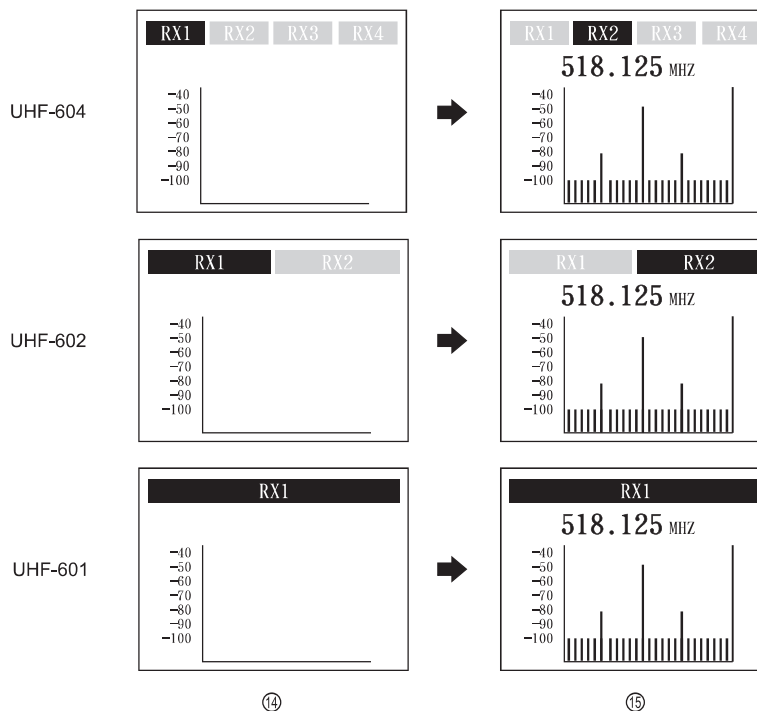

- ▶ Press the SELECT button to select the desired receiver channel RX1/2/3/4.
- ▶ Press the control knob to start scanning (Fig. 14).
When the scan is complete, the display shows the ideal frequency and the receiver channel automatically accepts the setting (Fig. 15). You can now synchronize a transmitter (→Section 6.2).
- ▶ The display of the receiver unit shows the RFI value (radio frequency interference) at the top right. The lower the value, the less interference there is (000 = minimum).
- ▶ Press the SELECT button to exit the setting mode.

CH1	RFI:000
	518.125 MHz

4.9 ID verification

You can avoid unintentional synchronization with an incorrect transmitter by using IP verification. When the ID verification is enabled, the receiver units only connect to transmitters that have already been synchronized. This prevents incorrect use and interference from external radio transmitters.

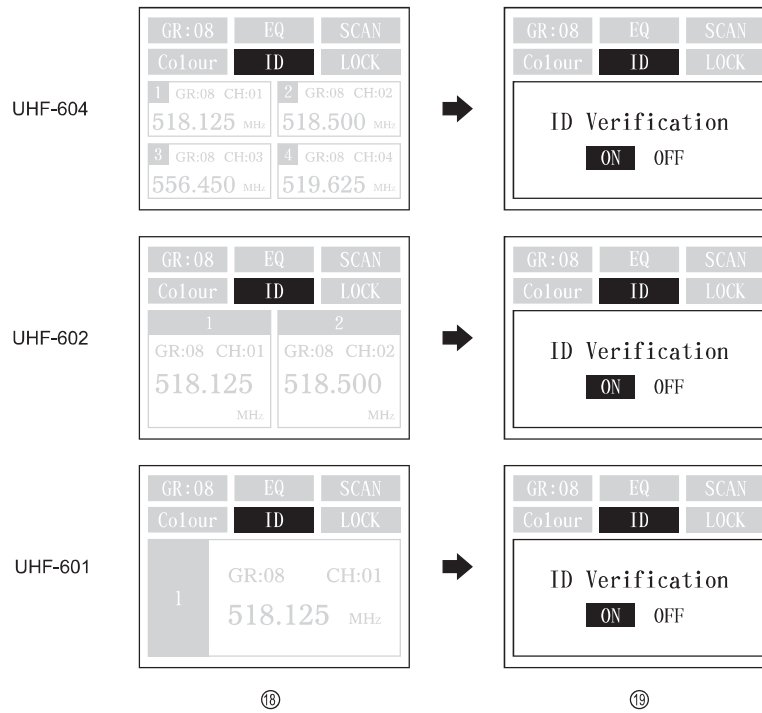

- ▶ In the receiver menu “RX Set”, use the SELECT button and the control knob to select the “ID” menu item (Fig. 18).
- ▶ Turn the control knob and select the ON setting (Fig. 19).
- ▶ Press the control knob to confirm.
- ▶ Press the SELECT button to exit the setting mode.

4.10 Enabling lock mode

You can lock the device against unintentional operation. When lock mode is switched on, it is not possible to change settings. For normal operation, the lock mode must be switched off again.

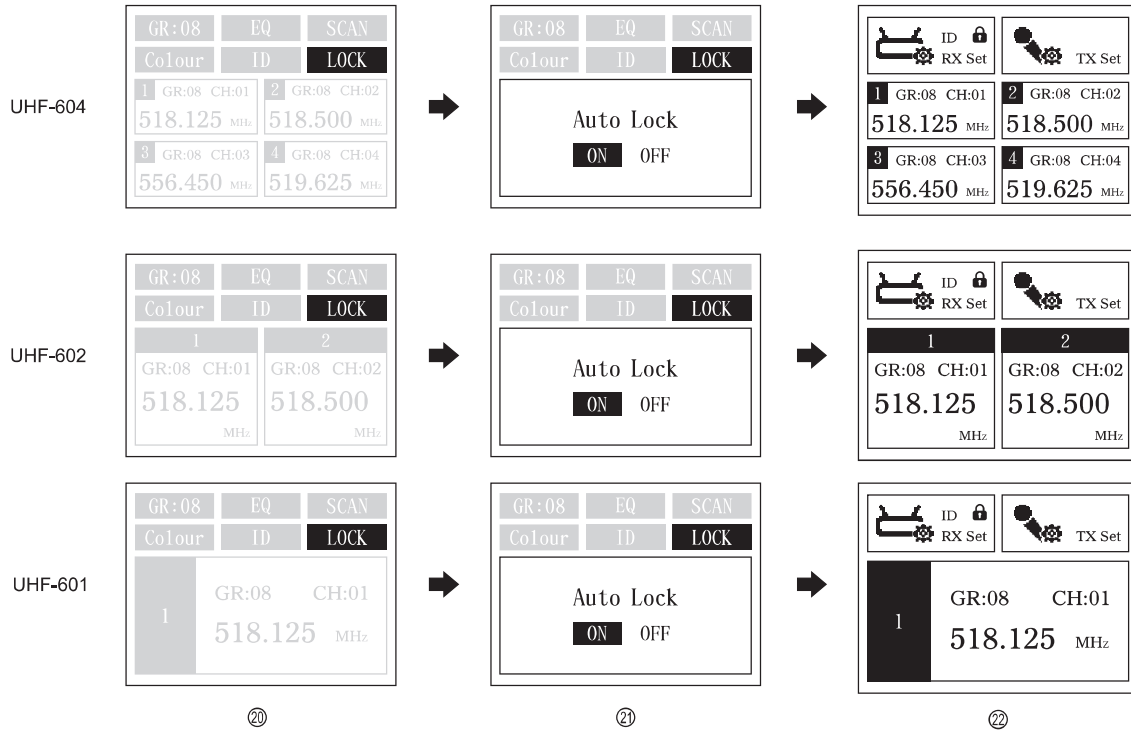

- ▶ In the receiver menu “RX Set”, use the SELECT button and the control knob to select the “LOCK” menu item (Fig. 20).
- ▶ Turn the control knob and select the ON setting (Fig. 21).
- ▶ Press the control knob to confirm. 30 seconds after pressing the last button, lock mode is enabled. The display shows a lock and it is not possible to change settings (Fig. 22).

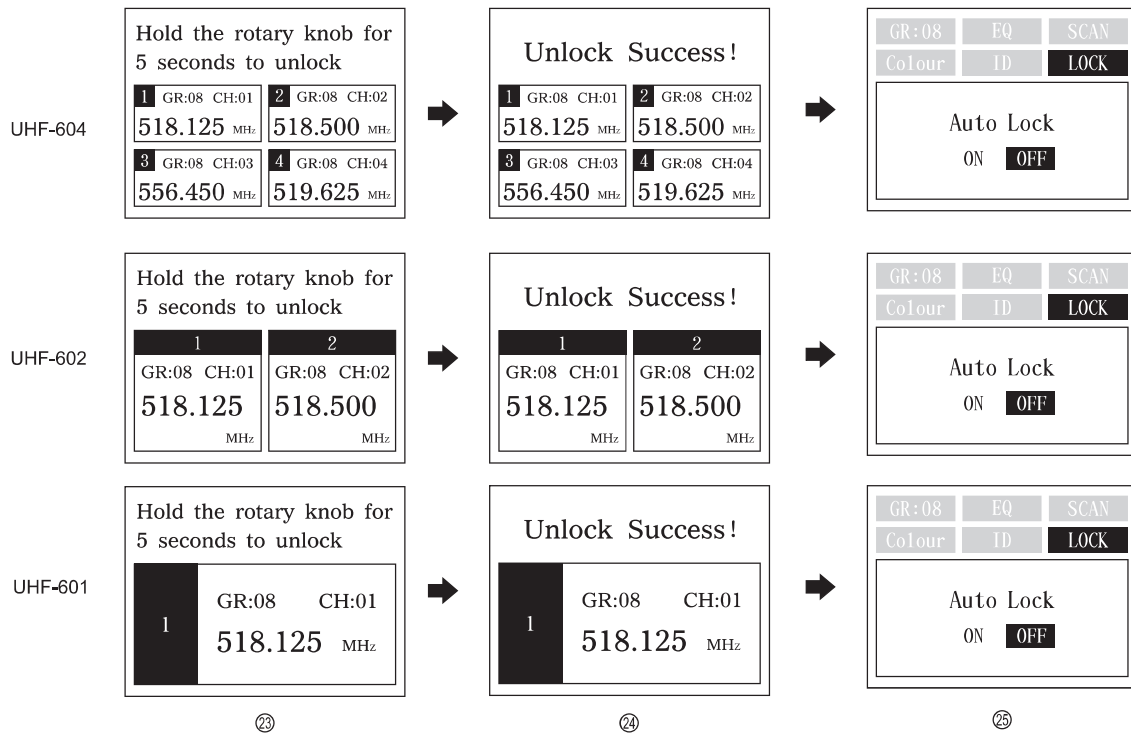

- ▶ When attempting to change settings, the display shows a prompt to unlock (Fig. 23).
- ▶ Press the control knob for 5 seconds to temporarily disable lock mode. The display shows "Unlock Success!" (Fig. 24).
- ▶ 30 seconds after pressing the last button, lock mode is enabled again. To disable lock mode permanently, select the OFF setting in the LOCK menu item (Fig. 25).
- ▶ Press the SELECT button to exit the setting mode.

4.11 Settings in the transmitter menu TX Set

In the TX Set menu, you can set the display lighting and the transmission power of the transmitters. Once you have made your settings, the devices must be synchronized for the changes to take effect.

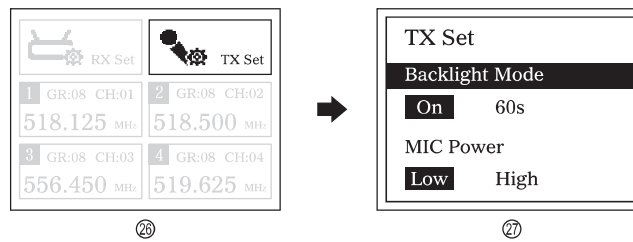

- ▶ Call the transmitter menu "TX Set" with the SELECT button (Fig. 26).
- ▶ Then press the control knob to call the menu items (Fig. 27).
- ▶ Press the control knob to switch between the "Backlight Mode" and "MIC Power" menu items.

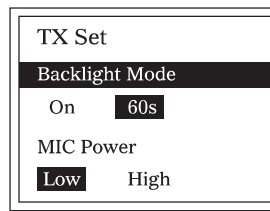

28

- ▶ In the "Backlight Mode" menu, turn the control knob and select a setting for the display:
ON = lighting always on, 60S = lighting off 60 seconds after pressing the last button.

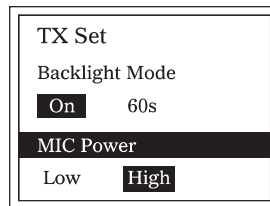

29

- ▶ In the "MIC Power" menu, turn the control knob and select a setting for the transmission power:
Low = low transmission power (shorter range with longer battery life),
High = high transmission power (long range with shorter battery life)
- ▶ After synchronization, the displays of the transmitters show the setting as follows:

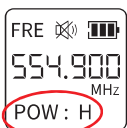

Microphone



Bodypack

5 Receiver Installation

5.1 Placing the receiver

- ▶ Place the receiver on an even surface. When choosing a location for the device, make sure that warm air can flow freely through all ventilation openings and that there is sufficient distance to other devices.
- ▶ If you are not mounting the receiver in a rack, you can attach the supplied feet to the bottom of the unit.

5.2 Connecting the antennas

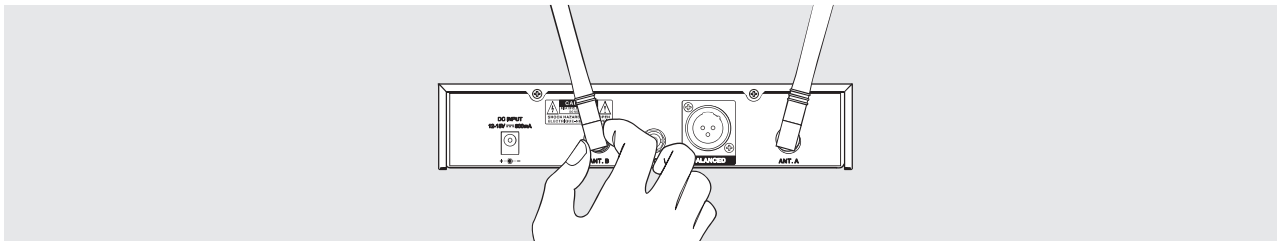

- ▶ Connect the antennas provided to the antenna jacks and lock them in place using the integrated bayonet catch. Put the antennas upright in a V-shaped position.
- ▶ The antennas provided are suitable for use in good reception conditions. The microphone system can thus be put into operation without great installation effort. In order to ensure optimal reception even in the case of poor reception conditions, the use of remote antennas and, if necessary, an antenna splitter is recommended. For rack mounting, the rod antennas can be attached to the front panel. If you operate more than one receiver, you should generally use remote antennas.

Notes

- In order to ensure sufficient cooling of the unit, air must always be able to flow freely through all air vents.
- Place the receiver at least 1 meter above the ground and not too close to lateral walls.
- Avoid sources of interference such as metal surfaces or electronic devices (e.g. computer, CD player).
- Ideally, position the receiving antennas at the height of the transmitter. When using multiple systems, do not allow antennas to cross or touch each other.
- For optimum reception, keep the transmitter at least 1 meter away from the receiver and avoid obstacles.

5.3 Rack mounting

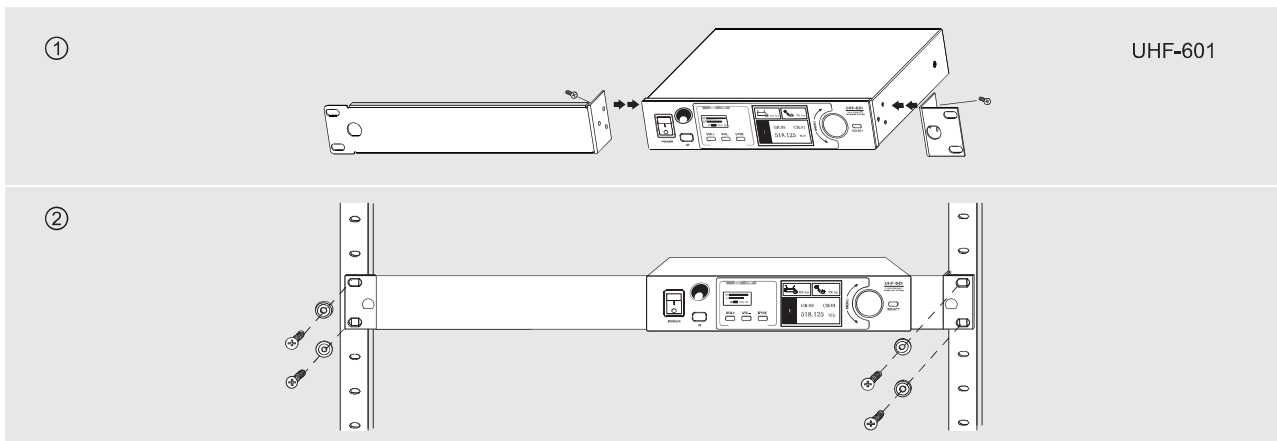

- ▶ For installation in a 19" rack (483 mm), two mounting brackets are included with the UHF-601 model. Screw on the mounting brackets at the left and right sides of the housing.

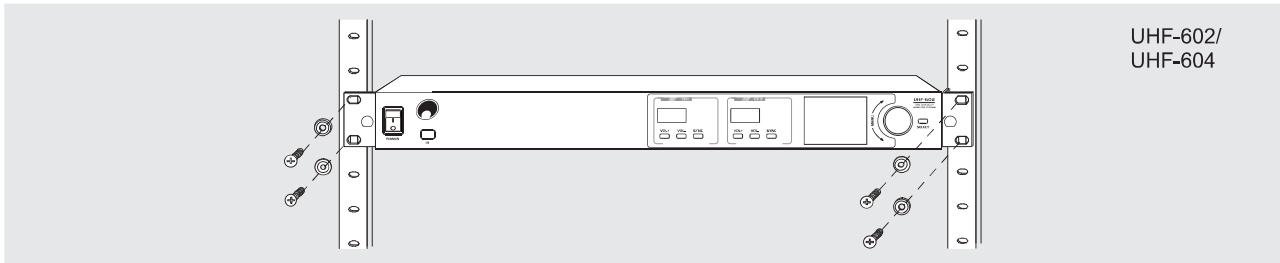

- ▶ Connect the supplied rod antennas to the back of the receiver or mount them to the front through the openings in the brackets. Suitable BNC extensions are available as accessories.
- ▶ For rack mounting, you should generally use remote antennas and, if necessary, an antenna splitter.
- ▶ Slide the receiver into the rack. Fasten the mounting brackets to the rack with four screws (M6).

5.4 Connecting an amplifier or mixing console

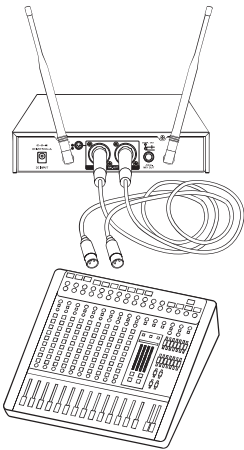

- ▶ Connect the receiver through one of the audio outputs to e.g. a mixer or amplifier. Before doing so, you should set the input level of the following device to minimum. The balanced XLR outputs of the individual channel outputs can be connected to a microphone input each of a mixer.
- ▶ Use the unbalanced 6.3 mm jack "MIX OUT" for the master signal of all receiving channels for connection to a microphone input or a highly sensitive line input via the connection cable provided.

5.5 Connecting the power adapter

- ▶ Connect the power adapter to the power input of the receiver and the mains plug to a mains socket. Pass the cable through the cable grip. Always disconnect the mains connector when you wish to change connections, move the unit to a different place or if it is not used for a longer period.

6 Receiver Operation

6.1 Establishing a radio link

To establish a radio link between a microphone and the receiver, the same frequency must be set in both devices. You can do this in a number of different ways:

- ▶ Set a frequency in the receiver manually and synchronize it with the microphone.
 - 1) Switch on all receivers.
 - 2) Set all receivers to the same channel group using menu item **Group** function (→Section 4.4).
The channels within a group are matched and free of intermodulation. Change the group if interference occurs at the site.
 - 3) Select a different transmission channel for each receiver using menu item **Channel** (→Section 4.5).
 - 4) After your configuration, switch on the microphones and synchronize the devices one by one via the infrared interface (→Section 6.2).

- ▶ Use the automatic frequency setup for each receiver.

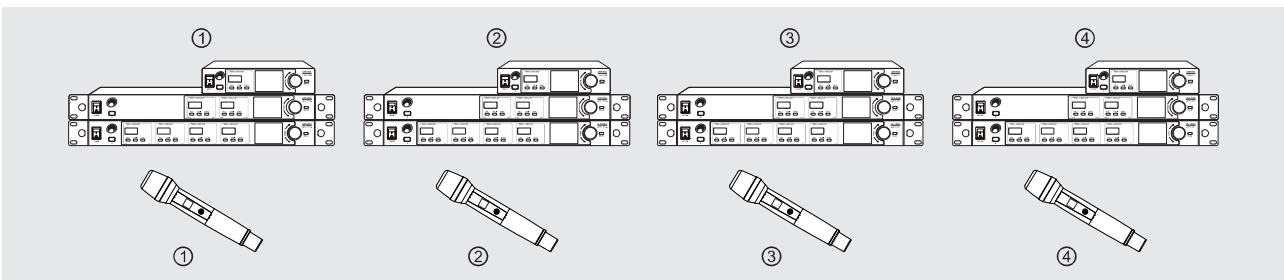

- 1) Switch on all receivers. Leave the microphones switched off.
- 2) Scan for an interference-free transmission frequency using menu item **Scan** (→Section 4.7).
- 3) Synchronize the receiver with a microphone via the infrared interface (→Section 6.2). The first radio link is now established.
- 4) Set up the other radio links in the same way. Always leave the microphones that have been set up switched on before performing an automatic frequency scan, so that the frequencies already being used will be skipped during the scan.

6.2 Synchronizing devices

You can synchronize the receiver with a microphone via the device's infrared interface.

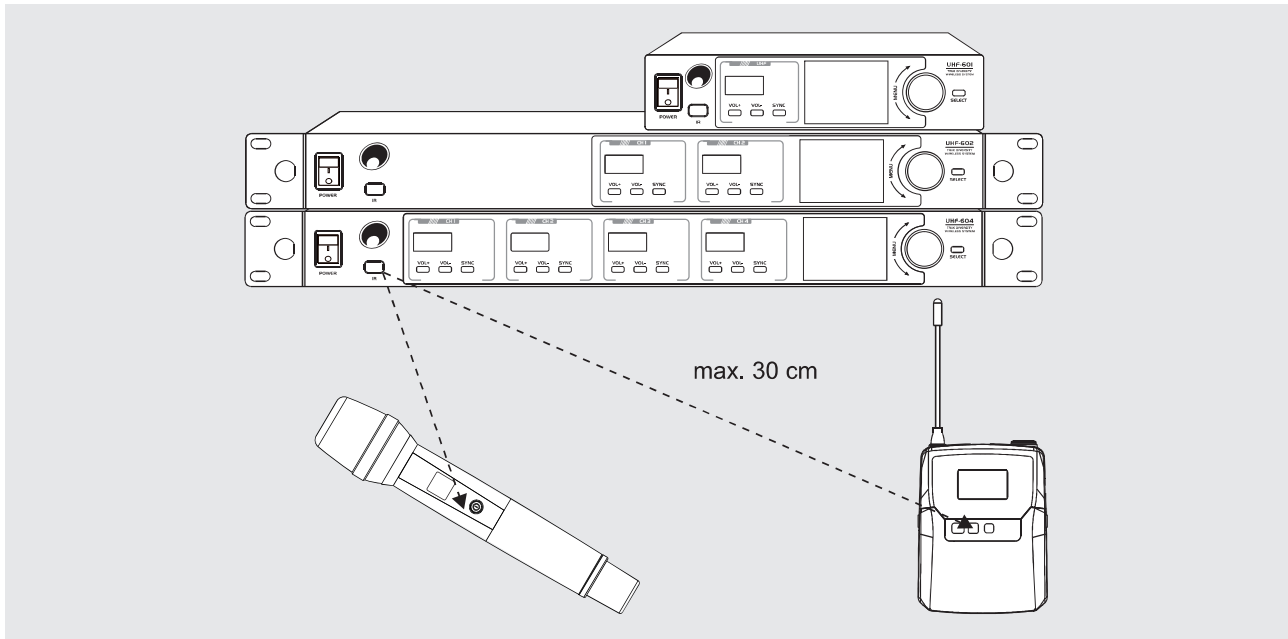

- ▶ Switch on the receiver and the transmitter.
- ▶ Press the **Sync** button of the corresponding receiver unit on the receiver.
The sync symbol will pulsate in the display.

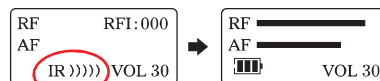

- ▶ Hold the transmitter's infrared interface in front of the receiver's infrared interface (max. 30 cm distance).
When the transfer is complete, the display shows the RF radio signal level, AF audio level and the transmitter's battery status.

6.3 Adjusting the level



- ▶ Switch on the following audio unit or advance the respective fader on the mixer. Speak into the microphones and match the output level of the individual reception channels to the input of the following unit with the VOL-/VOL+ volume controls. The AF indicators of the reception channels light up when an audio signal from the corresponding microphone is received.
- ▶ The sensitivity and therefore the volume level of the bodypack can be adjusted in 4 steps using the MODE button (Line, Low, Mid, High). Reduce the sensitivity if the signal from the bodypack is too high and therefore distorted. Increase the sensitivity if the volume is too low, resulting in a poor S/N ratio.
- ▶ To mute a transmitter, briefly press the operating switch on the microphone or the MUTE button on the bodypack. Then no sound will be transmitted. The  symbol appears on the displays.

7 Product Overview Transmitters

7.1 Microphone

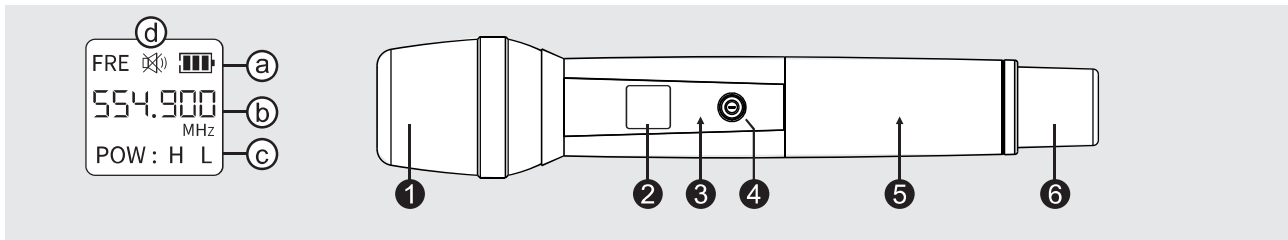

No.	Element	Function
1	Microphone module	Dynamic capsule with cardioid characteristic.
2	Display	a: Battery capacity → b: Radio frequency c: Transmission power d: Mute
3	Infrared interface	For synchronization with the receiver.
4	On/off and mute button	<ul style="list-style-type: none"> Press for 2 seconds to switch on/off. Short-press to enable/disable muting.
5	Battery compartment	Insert two 1.5 V batteries here (type AA, LR06).
6	Transmission antenna	Do not cover during operation.

7.2 Bodypack

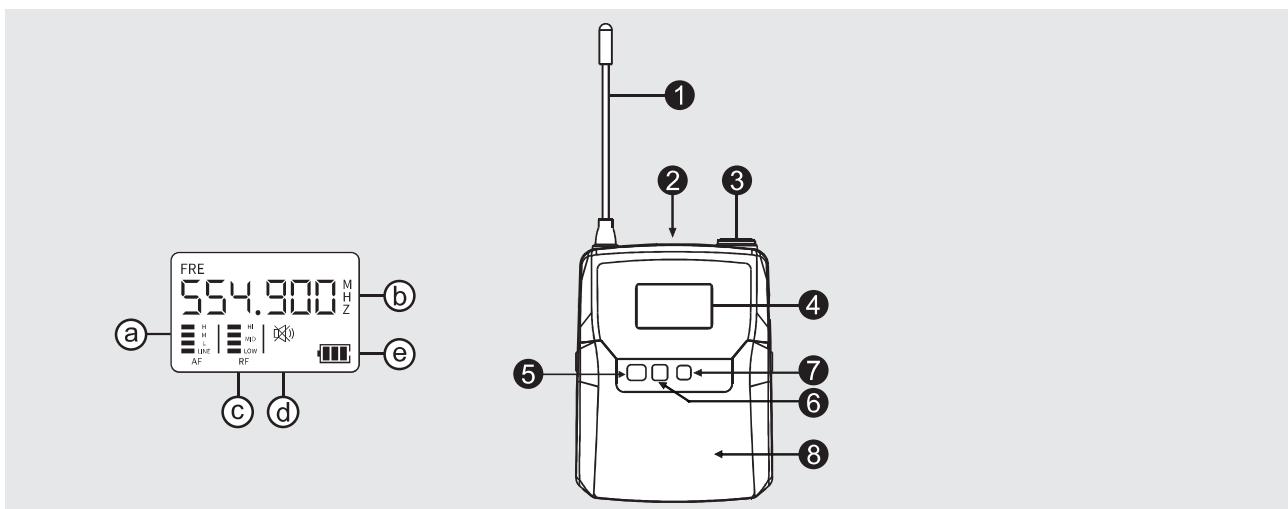

No.	Element	Function
1	Transmission antenna	
2	MUTE button	Muting enabled/disabled
3	Microphone input	Mini XLR jack for connecting a microphone.
4	Display	a: Gain level b: Radio frequency c: Transmission power d: Mute e: Battery capacity → fully charged exhausted
5	ON button	Press for 2 seconds to switch on/off.
6	Infrared interface	For synchronization with the receiver.
7	MODE button	To adjust the input sensitivity in 4 steps.
8	Battery compartment	Insert two 1.5 V batteries here (type AA, LR06).

8 Problem Chart

Problem	Remedy
Receiver has no power.	<ul style="list-style-type: none"> • Check connection cable of power unit and any extension cables.
No sound; receiver RF indication does not light.	<ul style="list-style-type: none"> • Make sure transmitter and receiver are switched on and the antennas are installed. • Check receiver battery indication to ensure that batteries are providing power. Replace batteries if necessary. • Make sure that receiver is in line of sight of transmitter. If necessary, reduce distance between transmitter and receiver.
No receiver sound; receiver RF indication lights.	<ul style="list-style-type: none"> • Turn up the level on receiver and/or pocket transmitter. • Check for proper connection between transmitter and mixer/amplifier. • Apply signal to transmitter and observe receiver's AF indication. If it lights up, the problem is elsewhere in the sound system.
Received signal is noisy or contains extraneous sounds with transmitter on.	<ul style="list-style-type: none"> • Check transmitter's battery indication to ensure that battery is providing power. • Remove local sources of HF interference, such as lighting equipment. • Check RFI value in the display. Perform a frequency scan if the value is high. • Two transmitters may be operating on the same frequency. Locate and turn one off. • Signal may be too weak. If possible, move receiver closer to transmitter.
Noise from receiver with transmitter off.	<ul style="list-style-type: none"> • Remove local sources of HF interference, such as lighting equipment. • Check RFI value in the display. Perform a frequency scan if the value is high. • Reposition the receiver.
Momentary loss of sound as receiver is moved around performing area.	<ul style="list-style-type: none"> • Reposition transmitter and perform another test and observe RF indication. If audio drop-outs persist, mark dead spots in performing area and avoid them during performance.

9 Technical Specifications

Receiver	
System:	True diversity
Range:	60 m (with line of sight)
Modulation:	FM
Frequency response:	50-16000 Hz
S/N ratio:	>80 dB
THD:	<0.5 % at 1 kHz
Audio outputs:	XLR, bal. and 6.3 mm jack, unbal.
Antenna inputs:	2 x BNC
Control elements:	Power switch, level control per channel, encoder
Sound processing:	7-band equalizer
Display:	TFT full color
Power supply:	12 V DC, 1000 mA via supplied power adapter connected to 100-240 V, 50/60 Hz
Power consumption:	6 W
Dimensions, Weight UHF-601:	205 x 212 x 44 mm (WxDxH), 935 g Rack installation with 1 U with supplied mounting brackets
Dimensions, Weight UHF-602/604:	485 x 212 x 44 mm (WxDxH), 1.5 kg Rack installation with 1 U

Hand-held microphone	
Capsule type:	Dynamic
Polar pattern:	Cardioid
RF power output:	520-554 MHz: 20 mW (LO), 30 mW (HI) 823-832/863-865 MHz: 5 mW (LO), 10 mW (HI)
Display:	LCD
Switch:	On/off/mute
Power supply:	2 x 1.5 V battery, type AA (not included)
Power consumption:	<130 mA
Dimensions:	259 x 49 mm (LxØ):
Weight:	350 g

Bodypack (optional)	
RF power output:	520-554 MHz: 20 mW (LO), 30 mW (HI) 823-832/863-865 MHz: 5 mW (LO), 10 mW (HI)
Display:	LCD
Control elements:	On/Off, Mute, Gain
Connection:	3-pin mini XLR (supplies 3 V)
Power supply:	2 x 1.5 V battery, type AA (not included)
Dimensions:	66 x 85 x 28 mm (WxDxH)
Weight:	74 g

Specifications are subject to change without notice due to product improvements.

9.1 Item numbers

Frequency range	Receiver	CH	Microphone	Bodypack
520-554 MHz	No. 13063601	1	No. 13063607	No. 13063609
	No. 13063603	2		
	No. 13063605	4		
823-832 MHz / 863-865 MHz	No. 13063600	1	No. 13063606	No. 13063608
	No. 13063602	2		
	No. 13063604	4		

9.2 Radio frequencies

The wireless systems are available in two frequency bands. The frequency bands have 10 channel banks with 12 channels each. Depending on the local conditions, you can operate up to 12 channels from these two frequency bands in parallel without interference.

Frequency range 520-554 MHz

CH	Group 1	Group 2	Group 3	Group 4	Group 5	Group 6	Group 7	Group 8	Group 9	Group 10
1	523.900	529.600	521.800	554.000	531.400	542.500	520.000	522.700	547.000	544.000
2	526.300	520.600	553.300	520.000	520.000	546.700	530.500	526.600	550.300	548.200
3	530.500	522.400	541.300	530.500	522.700	548.800	524.500	529.600	544.900	542.200
4	544.300	525.400	527.500	551.800	533.200	551.800	527.800	533.200	522.700	541.300
5	547.900	543.700	542.200	533.500	524.800	524.200	542.800	520.300	521.800	523.300
6	550.600	546.400	549.400	527.800	547.000	522.400	544.300	533.800	523.300	529.000
7	554.000	549.700	544.300	546.700	541.300	520.900	546.400	541.900	527.800	524.800
8	522.400	542.500	524.200	547.600	547.900	523.000	549.400	520.900	529.600	550.000
9	552.700	520.900	520.000	545.200	550.600	550.300	531.700	531.700	554.000	527.800
10	526.900	524.500	551.500	520.600	544.600	543.700	520.900	521.800	549.700	522.100
11	545.800	530.800	550.300	523.900	524.200	523.300	548.200	550.300	530.800	524.200
12	533.500	533.200	526.000	549.400	533.800	552.700	544.900	548.800	551.800	522.700

Frequency range 823-832 MHz and 863-865 MHz

CH	Group 1	Group 2	Group 3	Group 4	Group 5	Group 6	Group 7	Group 8	Group 9	Group 10
1	823.300	829.300	824.800	824.500	825.700	825.400	826.000	826.900	826.000	828.400
2	827.500	823.600	830.500	828.400	832.000	831.400	832.000	865.000	831.400	863.600
3	830.200	863.000	863.300	831.700	863.600	865.000	863.600	830.800	823.000	832.000
4	863.000	832.000	827.500	863.600	823.000	828.100	823.300	823.600	863.600	825.400
5	832.000	826.900	823.000	823.000	827.800	823.000	827.800	828.700	823.600	823.600
6	823.900	823.000	823.600	825.400	823.900	827.500	823.900	824.200	827.800	823.000
7	865.000	865.000	864.500	829.000	830.200	863.300	865.000	863.600	865.000	830.500
8	826.300	831.100	831.100	865.000	865.000	829.300	830.800	831.700	828.700	865.000
9	825.400	825.400	829.000	826.600	826.600	823.900	825.700	823.000	824.800	829.300
10	824.500	828.100	828.400	830.800	830.800	824.500	825.100	828.100	825.400	826.300
11	864.500	863.600	826.000	863.000	863.000	829.900	823.000	826.300	824.500	831.100
12	826.900	829.000	864.200	823.600	829.000	826.600	831.400	863.000	863.000	824.200

Connector configuration

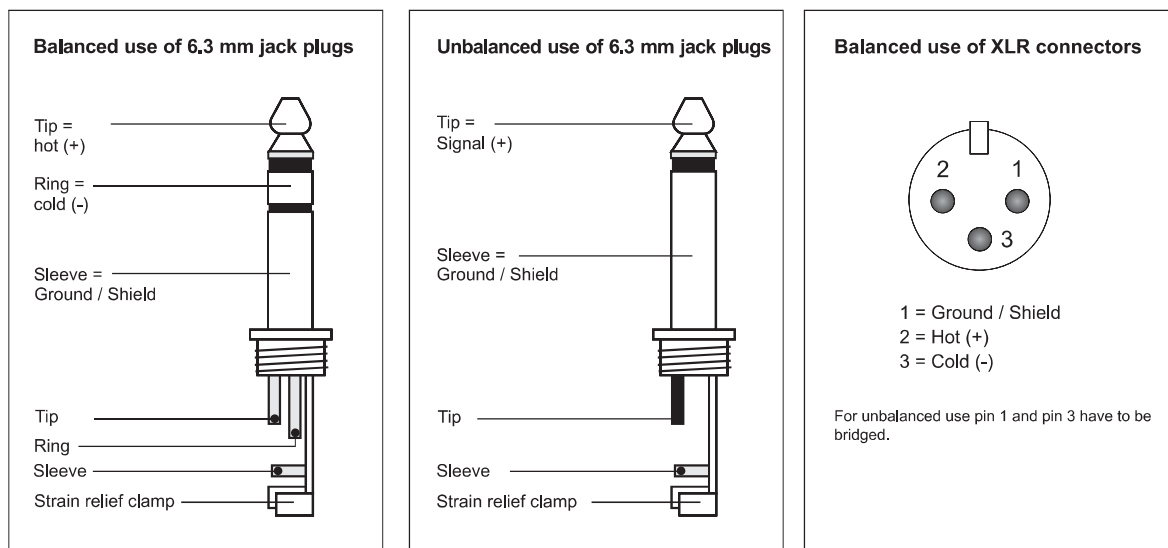



WWW.OMNITRONIC.DE

TECHNOLOGY DESIGNED FOR PLEASURE

