

MOOER

F15i Li

INTELLIGENT AMP

Owner's Manual

CONTENT

PRECAUTIONS	1
PRODUCT FEATURES.....	2
PANEL OVERVIEW	3
DEVICE CONNECTION	6
QUICK START GUIDE	8
OPERATION.....	16
MOOER iAMP APPLICATION	26
MOOER STUDIO FOR FUTURE SERIES	49
EFFECT DESCRIPTIONS	51
TECHNICAL SPECIFICATIONS.....	57
TROUBLESHOOTING	59

PRECAUTIONS

PLEASE READ CAREFULLY BEFORE PROCEEDING

Power supply

Please connect the DC POWER supply to an AC outlet of the correct voltage. Please be sure to use only an AC adapter that supplies 5 VDC, center negative, 2 A current draw. Unplug the power adapter when not in use or during electrical storms.

Connections

Always turn off the power of the amplifier and other devices before setting up the connection to avoid malfunction and unexpected damage. In addition, before you move the amplifier, please ensure the amplifier is powered off and disconnect it from other devices. Please power off the amplifier and unplug the power supply if the amplifier is not used for a long period of time. Please do not use the amplifier during an electric storm. Power off the device and unplug the power cord from the socket

Location

To avoid deformation, discoloration or other serious damage, do not expose this device to any of the following conditions:

- direct sunlight
- extreme temperature or humidity
- excessively dusty or dirty locations
- magnetic fields
- high humidity or moisture
- strong vibrations or shocks

Cleaning

Clean only with a soft, dry cloth. If necessary, lightly moisten the cloth. Do not use abrasive cleaners, cleaning alcohol, paint thinners, wax, solvents, cleaning fluids, or chemical-impregnated wiping cloths.

Operation

- Please do not use excessive force to operate knob and switches.
- Please do not let paper scraps, metal debris or other items fall into the unit.
- Please do not drop the unit, and avoid heavy blows.
- Please do not modify the unit without authorization.
- Should repairs be required, please contact the MOOER support team for more information.

PRODUCT FEATURES

- Future Series Desktop Speaker, equipped with the Mooer iAMP effect system.
- 15W stereo amplifier with 2 x 2-inch speakers.
- 1.28-inch circular touch screen for status display and convenient function control.
- 2 line output interfaces for connecting to external amplification equipment.
- Headphone interface for silent practice.
- 55 speaker simulations based on MNRS reverse modeling technology, and 69 effect types.
- 60 drum machine rhythm patterns and 10 metronome types.
- 60-second phrase looper, supports synchronization with drum machine.
- Built-in tuner to maintain instrument tuning at all times.
- Built-in rechargeable battery, providing wireless flexibility.
- Dedicated iAMP APP supports comprehensive effect editing, firmware updates, and cloud-based upload/download of tones.
- Supports Mooer F4 wireless footswitch for extended control.
- High-fidelity Bluetooth 5.0 audio input - amp can be used as a Bluetooth speaker or for accompanied practice.
- USB-C REC (OTG) interface supports high-quality audio recording and playback.

PANEL OVERVIEW



1. **Power button:**
A button with a LED. Press and hold to power on or off.
2. **TOOLS button:**
Press to enter or exit the Tools interface.
3. **TAP button:**
Press to set the tempo. In normal conditions the LED will flash indicating the current BPM value.
4. **TUNER button:**
Press to enter or exit the tuner interface.
5. **PRESET button:**
Press to enter the preset list or switch between the four presets of the same group.
6. **Screen:**
Displays all operational information for the device.
7. **VALUE encoder:**
Use the knob to switch presets, adjust drum machine parameters and more.
8. **MASTER knob:**
Rotate the knob to adjust the volume.
9. **3.5 mm headphone output:**
Insert headphones for audio output. A plug inserted here will mute the device's speakers.
10. **Ambient light:**
Multi-color ambient light that can indicate the parameter adjustment value in a progress bar during volume adjustments.
11. **6.35 mm instrument input:**
Connect a guitar or other instrument.

12. 6.35 mm outputs:

Connect to external active speakers or a mixing console.

13. USB interface:

Used for charging the device or for OTG digital audio recording and playback from mobile devices.

Note: This interface is intended for recording on mobile devices and cannot fully replace the low-latency audio interface functions in professional DAW software. To use it with a Windows DAW, third-party ASIO drivers are required, and driver compatibility issues may arise.

DEVICE CONNECTION

FRONT PANEL INTERFACES

Note: The built-in speakers will be muted when headphones are connected.



INTERFACES ON THE BACK

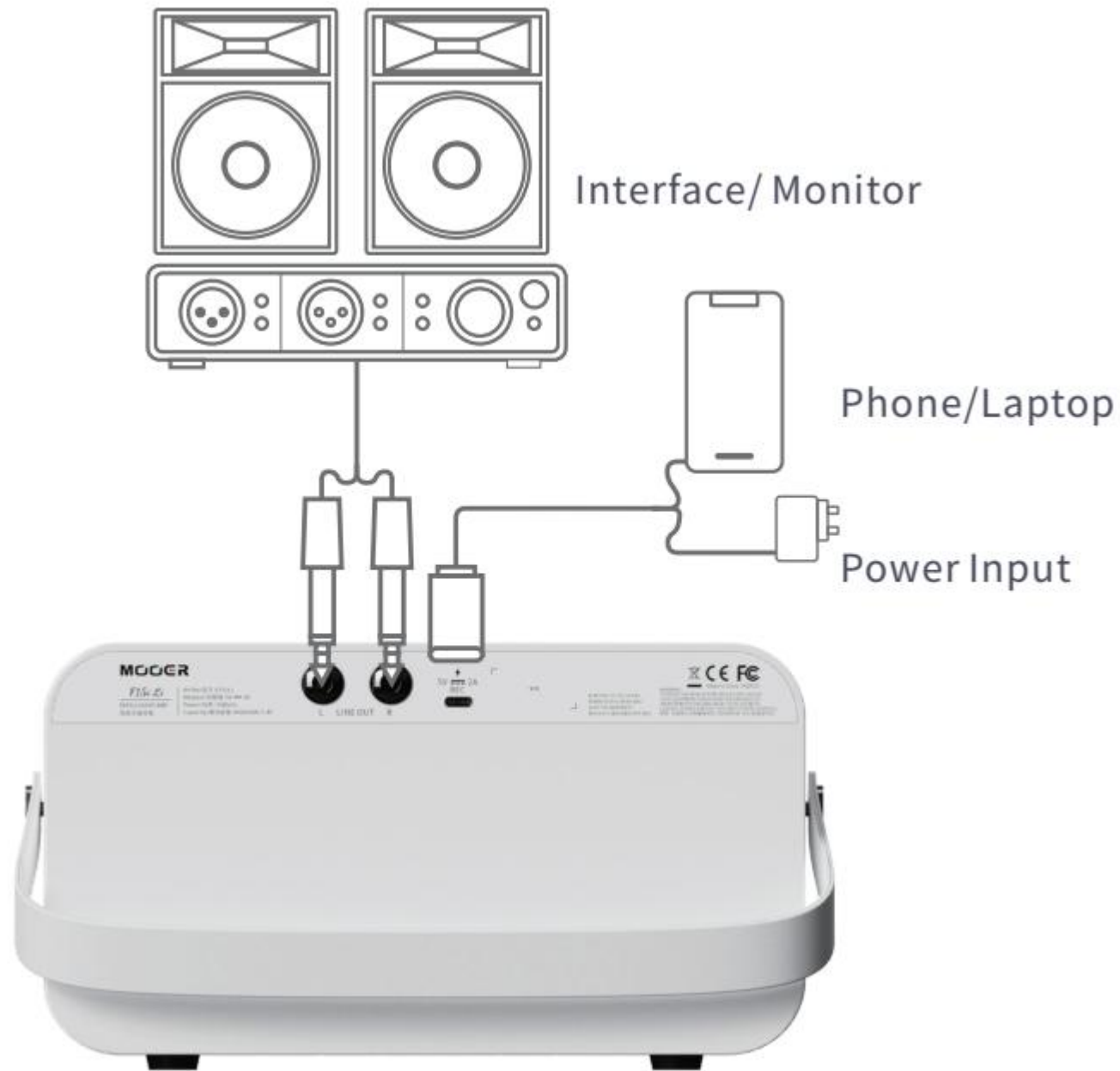

QUICK START GUIDE

POWER ON

To prevent sudden volume spikes that may damage the device, it is recommended to turn the MASTER knob to the lowest setting before powering on the device by pressing and holding the power button.

To avoid power noise and potential short-circuit issues, please use a power adapter that meets the required specifications (5V 2A).

THE INTERFACE

Preset Main Interface

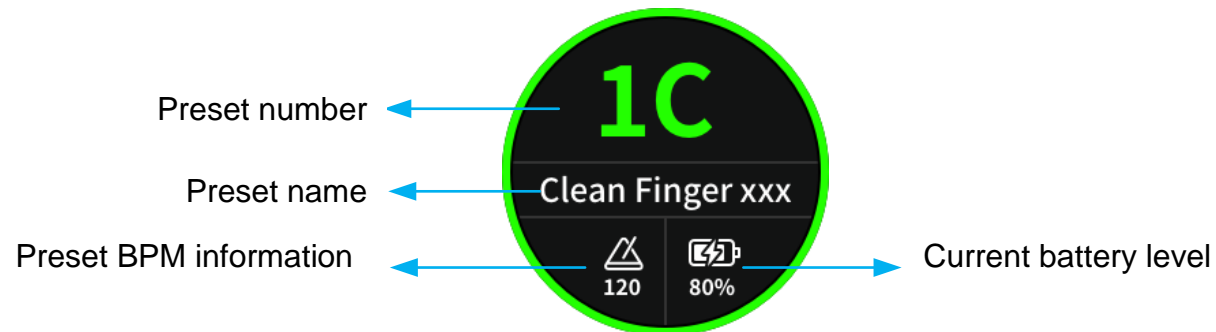

Tools Interface

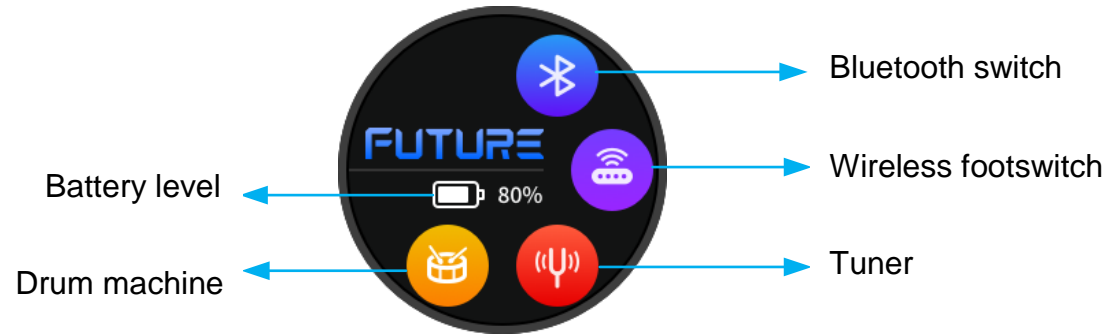

Drum Machine Interface



Tuner Interface



Bluetooth Audio Playback Interface

In the app, find the "Lyrics Display" option in the global settings and turn on this switch. When you play music over Bluetooth and no input is made on the amp for 3 seconds, the F15i Li will show the Audio Playback screen. In this interface, you can view the title, artist and album of the current song as well as the song duration, and other information in real-time. You can also perform actions such as Pause / Play and Previous Track / Next Track.



PANEL BUTTONS AND KNOBS

Power Button

Press and hold this button to power the device on or off. When powering off, a confirmation screen will appear on the device. Click "Yes" to turn off the device. (A short press will bring up the shutdown confirmation screen, and after holding for 3 seconds, the device will automatically shut down.)



Shutdown confirmation interface

TOOLS Button

Pressing this button in any interface will enter the **TOOLS** interface. Pressing it again will exit the tools interface and return to the **Preset Main Interface**.



Tools interface

TAP Button

In all interfaces, except for the drum machine and tuner interfaces, the **TAP button** will flash red to represent the BPM information. It will convert the BPM to a **Time value** in quarter-note increments and be linked to the delay module. In the **drum machine interface**, the TAP button will flash blue to represent the BPM. By pressing this button in a tapping rhythm, you can change the BPM of the drum machine.

TUNER Button

Pressing this button in any interface will enter the **TUNER** (tuner) interface. Pressing it again will exit the tuner interface and return to the **Preset Main Interface**.



Tuner interface

PRESET Button

- Pressing this button in any interface will return you to the **Preset Main** interface. This button acts as a "**HOME**" button.
- In the **Preset** interface, pressing this button will cycle through the four presets in the same group. The button's light will flash in different colors (blue, yellow, green, purple) to represent the **A**, **B**, **C**, and **D** presets of the group.
- When a preset parameter is changed, the button's light will flash red to indicate that the preset information has been modified. A long press of the button will save the changes.



Preset Main interface

VALUE Encoder

Using this encoder, you can perform operations such as switching presets, switching drum machine types, etc. When a parameter is selected on the screen, you can use this encoder to change the parameter.

MASTER Knob

This knob adjusts the main output volume of the device. When turning this knob, the device will briefly display the current adjusted volume value, and the ambient light bar will also show the current adjustment value in the form of a progress bar.



Temporary display when adjusting the main volume

OPERATION

The content above roughly introduces some of the hardware and simple connection scenarios of the device. The following sections describe how to make the most of the F15i Li and begin your exclusive musical journey.

PRESET SWITCHING

The F15i Li has 20 preset groups (Banks), each with 4 preset tones, offering a total of 80 presets. There are different ways to switch presets on the F15i Li:

Method 1:

In the Preset main interface, rotate the Value encoder to quickly switch between presets.

Method 2:

Press the "PRESET" button on the panel to switch between the four presets within the same group.

Method 3:

When connected to and using the MOOER F4 wireless footswitch, you can control preset switching using the footswitch. Press A, B, C, or D to switch between the four presets within the group. Press both A & B to go up one bank, and both C & D to go down one bank.

Method 4:

Open the iAmp app on your phone, connect it to the F15i Li, and access the interface. Click the preset dropdown menu to view and switch presets.

BLUETOOTH FUNCTION

In the TOOLS tool interface, click the Bluetooth icon to toggle the Bluetooth function on and off for the F15i Li.



After turning on the Bluetooth switch on the F15i Li, you can search for "F15i Li" in the Bluetooth search list on your phone. Once connected, you can use the F15i Li as a Bluetooth speaker to play backing tracks from your phone.

At the same time, when the Bluetooth switch is enabled, you can also use the iAmp app to connect to the F15i Li for fine-tuning adjustments.

WIRELESS FOOTSWITCH

The F15i Li supports the MOOER F4 wireless footswitch (sold separately). This footswitch can be used to control preset switching, drum machine, loop recording and provides Tap Tempo functionality.

For battery specifications and charging requirements, please refer to the F4 footswitch manual.

The F15i Li can only connect to one wireless footswitch at a time.

Wireless Footswitch Pairing

In the TOOLS interface, click the wireless footswitch icon, and the F15i Li will enter wireless footswitch pairing mode. The icon will dynamically show increasing signal strength during the connection process. At this point, long-press the **A+C** footswitches on the MOOER F4 wireless footswitch to enter pairing mode. When the icon turns purple, pairing is successful. If the icon turns gray again, pairing has failed, and you will need to retry pairing.



Wireless footswitch pairing successful

In the iAmp APP, click the wireless icon in the bottom operation bar of the main interface to enter the wireless footswitch pairing mode for the F15i Li. After the initial pairing, the footswitch can be used to control the F15i Li even when the iAmp app is inactive or disconnected.

Footswitch functions

Preset switching

The footswitch always indicates the selected preset, whether chosen via the F15i Li touch screen, the preset selection list in the iAmp app or the A/B/C/D buttons on the footswitch.

Press the A/B/C/D buttons to switch between four presets in the current bank.

The current preset is indicated by the corresponding LED above the footswitch button and displayed in the footswitch screen:

- the number represents the bank
- the letter represents the preset within the bank (e.g. "3d")
For better readability: A and C are upper case; b and d are lower case.
- Banks 10-19 are indicated by a dot after the number (e.g. "0.d = 10D / "9.A = 19A).

Bank switching

- Press A+B simultaneously to scroll down between banks.
- Press C+D simultaneously to scroll up between banks.
The preset indication on the footswitch flashes after selecting a bank, but the preset is not yet activated.
- Press one of the four footswitch buttons (A/B/C/D) to select a preset in the selected bank.
Only then will the preset be activated and the indicator stops flashing.

Tap Tempo

If the currently selected preset has the delay effect On, the relevant footswitch LED will blink according to the delay time value you set.

- Repeatedly press the footswitch several times to control the delay time directly. The tempo input must remain within the min/max range of the effect.

Note:

- The Tap Tempo mode is indicated by a dot behind the letter/number in the footswitch screen (e.g. "3.C.").
- Adjust the tempo while the dot is displayed. If no input is detected for 2.5 seconds, the Tap Tempo mode will be cancelled, the dot will disappear and the footswitch returns to preset selection mode.

Tuner

- Press and hold any footswitch to enter TUNER mode.

Note:

- If the iAmp app is active and connected, it will also enter TUNER mode. But you can use the footswitch for tuning without the App.
- The left part of the screen shows the closest note, while the right part shows the pitch. Semitones are indicated using "#".

- If the string is in tune, the right section remain still; if sharp, it will rotate clockwise; if flat it will rotate counterclockwise
- Press any footswitch briefly to exit Tuner mode and return to preset switching mode.

Note:

You can enable / disable silent tuning in the iAmp app.

Drum machine/Looper Control

The F15i Li features a built-in 60 second looper and a drum machine with 60 rhythm patterns plus 10 metronome types. Looper and drum machine can operate simultaneously.

Enter / leave Looper and Drum mode

- In the preset switching mode, press and hold footswitches B and C simultaneously to enter Drum Machine and Looper mode. The screen of the footswitch will show “LD”.
- Press and hold footswitches B and C again to return to preset selection mode.

Looper control

In D & L mode, footswitches A and B are used looper control:

- **A: REC/PLAY/OVERDUB**
Press A to start recording. Press A again to play the recorded track. Press A once more to begin overdubbing over the first track ... and so on.
- **B: STOP/Hold to CLEAR**
When recording or playback is stopped, the B LED will remain lit. Once the track is cleared, the LED will turn off.

Drum Machine control

In D & L mode, footswitches C and D are used for drum machine control:

- **C: Tap Tempo**
Use the Tap Tempo feature to adjust the BPM (beats per minute) for the Drum Machine: tap the footswitch C several times in succession to set the desired tempo.
The C LED will flash to indicate the selected tempo. The BPM value will also be displayed in the Drum Machine screen in the iAmp app.
- **D: Play/Stop**
Starts or stops Drum Machine playback.

Rhythm selection

- Press and hold footswitch C to enter Rhythm Selection Mode.
The screen will display the number of the currently selected rhythm pattern and both C and D LED will flash.
- Press footswitch C or D to scroll up or down through the available rhythm patterns.
- Consult the iAmp app for names and numbers of the patterns.
- Rhythm Selection Mode will automatically be cancelled when no input is detected for several seconds.

TUNER FUNCTION

After entering the **TOOLS** interface, click the tuner icon on the screen or press the **TUNER** button on the panel to enter the tuner interface.

Additionally, when paired with the F4 wireless footswitch, you can also enter the tuner interface by long-pressing the current preset footswitch.

We provide a reference pitch range from 430Hz to 445Hz, with the default pitch being A=440Hz. (To change the reference pitch, please use the iAmp APP. Detailed steps will be shown below.)

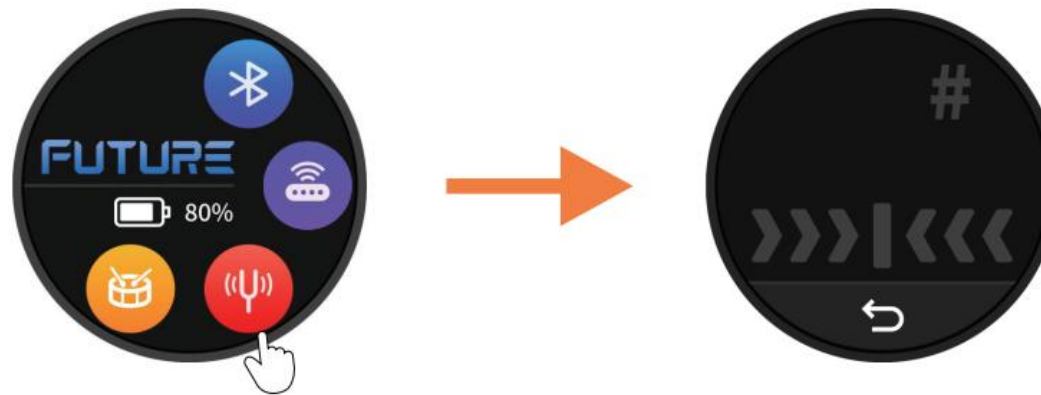

After entering the TUNER interface, the function operations are as follows:

- Click the return icon to exit the TUNER interface and return to the TOOLS interface.
- When the pitch is correct, the pitch information bar will fully turn green, and the pitch letter will also turn green.



- When the pitch is slightly off, the pitch information bar will be displayed in yellow.



- When the pitch is significantly off, the pitch information bar will be displayed in orange.



- When the pitch is severely off, the pitch information bar will be displayed in red.



DRUM MACHINE

In the F15i Li, we have prepared a total of 60 drum machine rhythm patterns covering various styles, along with 10 metronome types. In the **TOOLS** interface, click the drum machine icon to enter the drum machine interface.





After entering the drum machine interface, the following operations are available:

- Click the Start/Stop switch to turn the drum machine on or off.
- Tap on the TAP area to calculate the BPM based on the interval of your tapping.
- Click the volume adjustment area, and after selecting it, rotate the VALUE encoder to adjust the drum machine's volume.
- Click the rhythm pattern area, and after selecting it, rotate the VALUE encoder to choose the drum machine's rhythm pattern.
- Click the BPM adjustment area, and after selecting it, rotate the VALUE encoder to modify the drum machine's BPM.
- Click the return icon to exit the drum machine interface and return to the TOOLS interface.

Note: For more features of the drum machine, such as LOOPER synchronization and other functions, please use the iAMP APP.

MOOER iAMP APPLICATION

The following sections will focus on how to use the app in combination with the F15i Li, including device connection, home page settings, preset editing, mixer settings, personal center, tone cloud, global settings, tool list, wireless footswitch, and more.

DEVICE CONNECTION

First, prepare a smartphone and download the iAMP application from the Apple App Store, Google Play Store, or the MOOER official website, then install it on your mobile device.

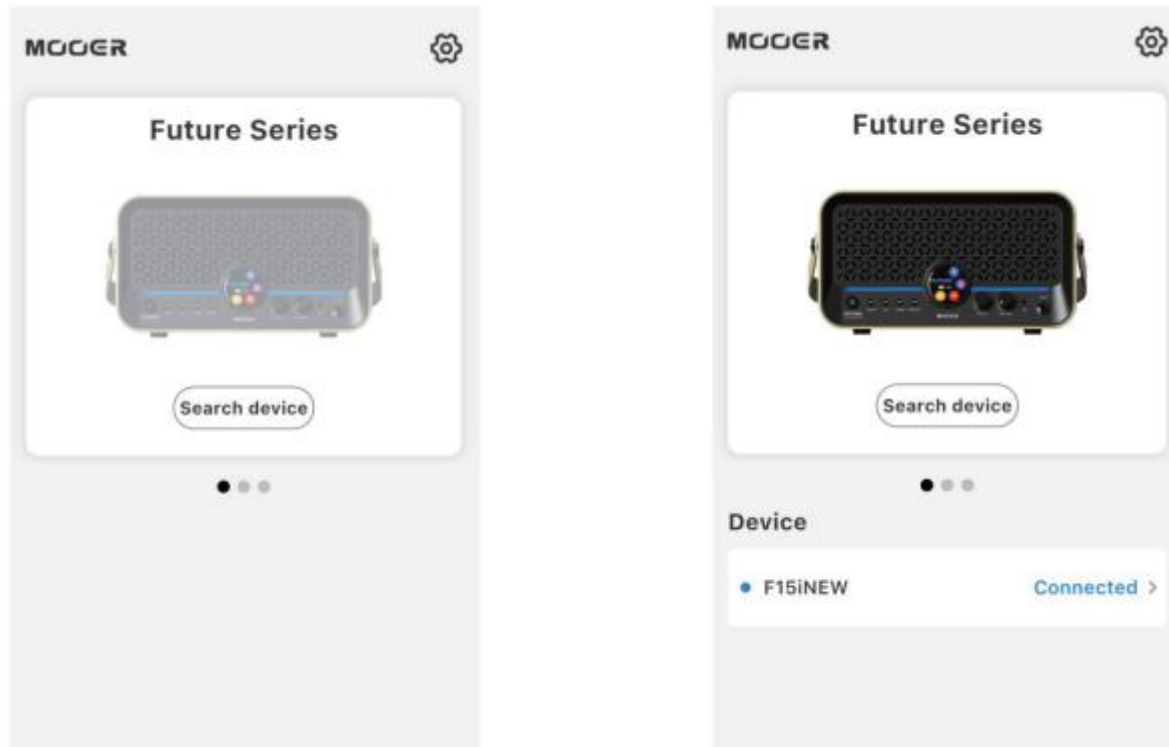

Enable Bluetooth and location services on your mobile device.

Open the iAMP application and slide the field with the device image to find the **FUTURE SERIES** tab. Tap **Search Device** and find your machine in the device list below, then tap **Connect**. After the connection progress bar completes, the F15i Li image will change from grayed out to full-color display. Tap the F15i Li image again to enter the user interface.

HOME PAGE SETTINGS

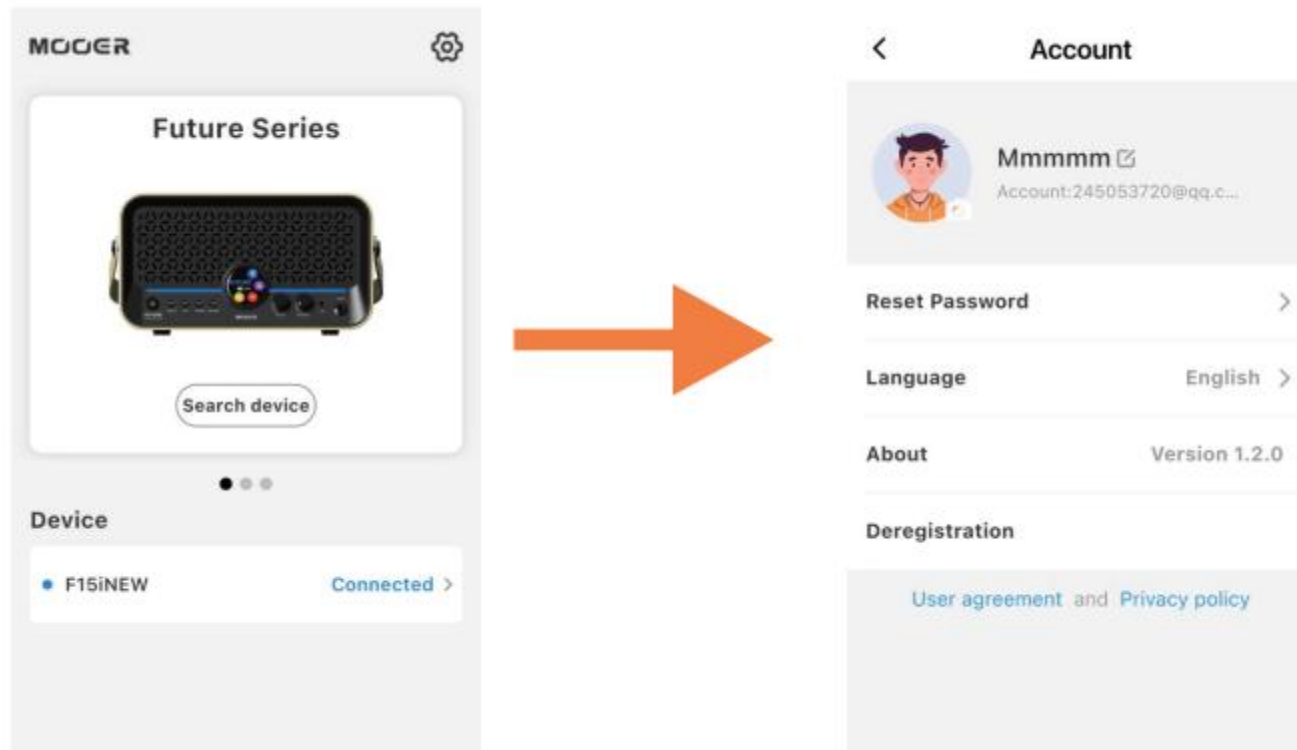

Tap the Settings icon in the upper right corner of the home page to enter the Home Settings interface. In this interface, you can log in, switch languages, and view version information. After logging in, you can also change your password, log out, and exit your account.

USER INTERFACE

Once the device is connected, tap the colorful F15i Li icon to directly enter the user interface. In this interface, users can perform most operations, such as switching presets, modifying parameters, changing algorithm models, and more.



Menu icon

Tap the menu icon to expand the left sidebar (further details will be provided later).

Top status bar

In the top status bar, you can tap the icons for Effect Chain, Tone Library, and Mixer to enter those sections.

Preset area

Tap the preset area to bring up the preset list. Tap the save icon on the right to open the save confirmation dialog.

Effect chain area

In this area, you can add or remove effect modules, move the effect chain, turn on/off effect modules, and perform other operations.

Editing area

In this area, the full parameters of the currently selected module will be displayed. You can change the effect model, adjust parameters, and more.

Bottom status bar

The bottom status bar allows you to return to the home settings, scan the serial number QR code, match the wireless footswitch, toggle Bluetooth, and view battery status.

PRESET EDITING

The F15i Li comes with 80 built-in preset tones, and by tapping the Tone Library in the top status bar, you'll also have access to 6 styles and 30 tones. However, if these presets don't quite match what you're looking for, or if you'd like to experience the joy of creating your own tones, let's begin the journey of tone creation!

Remove an effect module



In the effect chain interface, select the module you want to remove and drag it upwards to remove the module.

Add an effect module

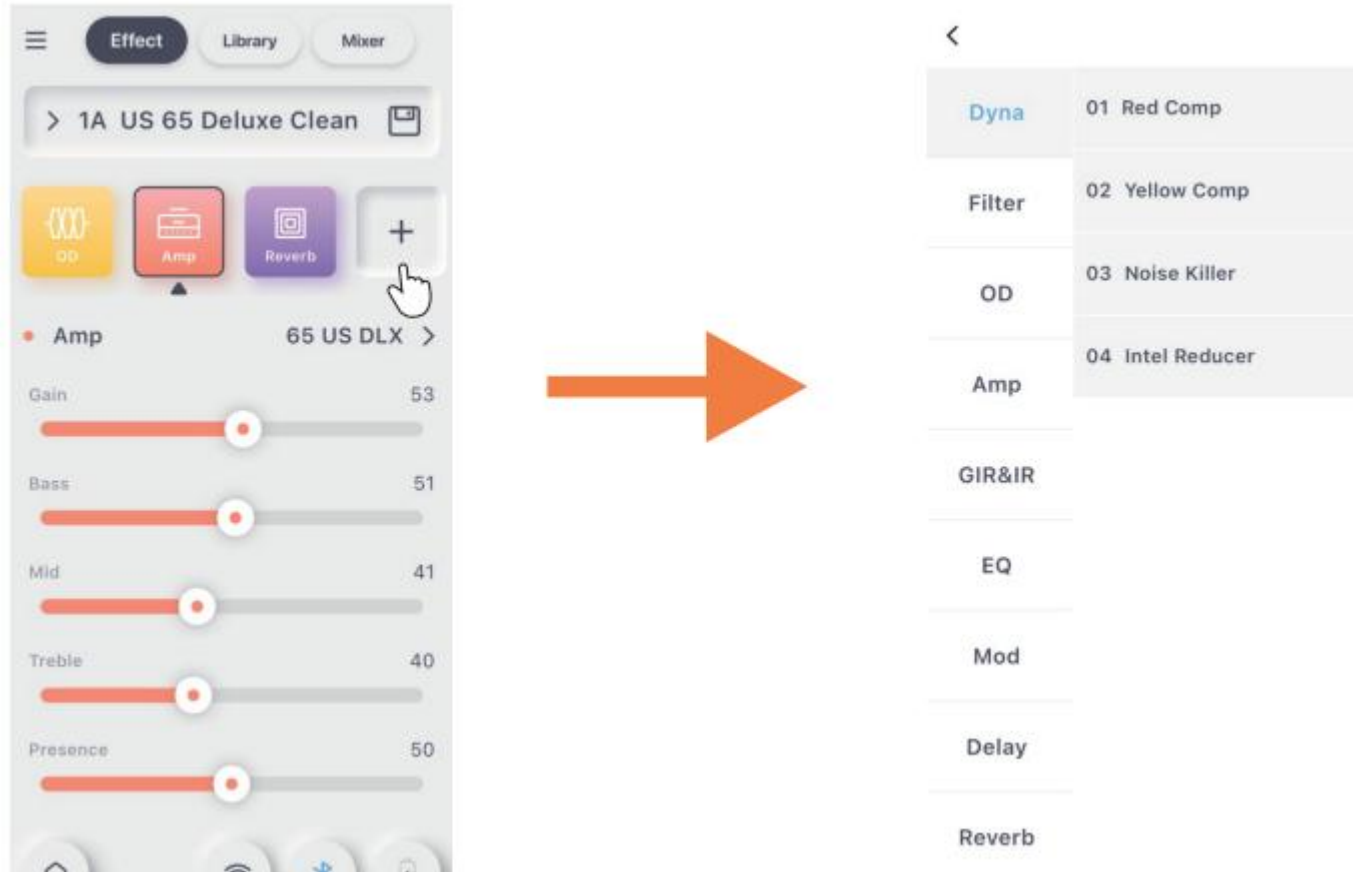

In the effect chain interface, click the blank '+' button to open the effect model list (the specific modules and corresponding model list will be provided in the upcoming 'Effect Description').

Change an effect model and modify parameters

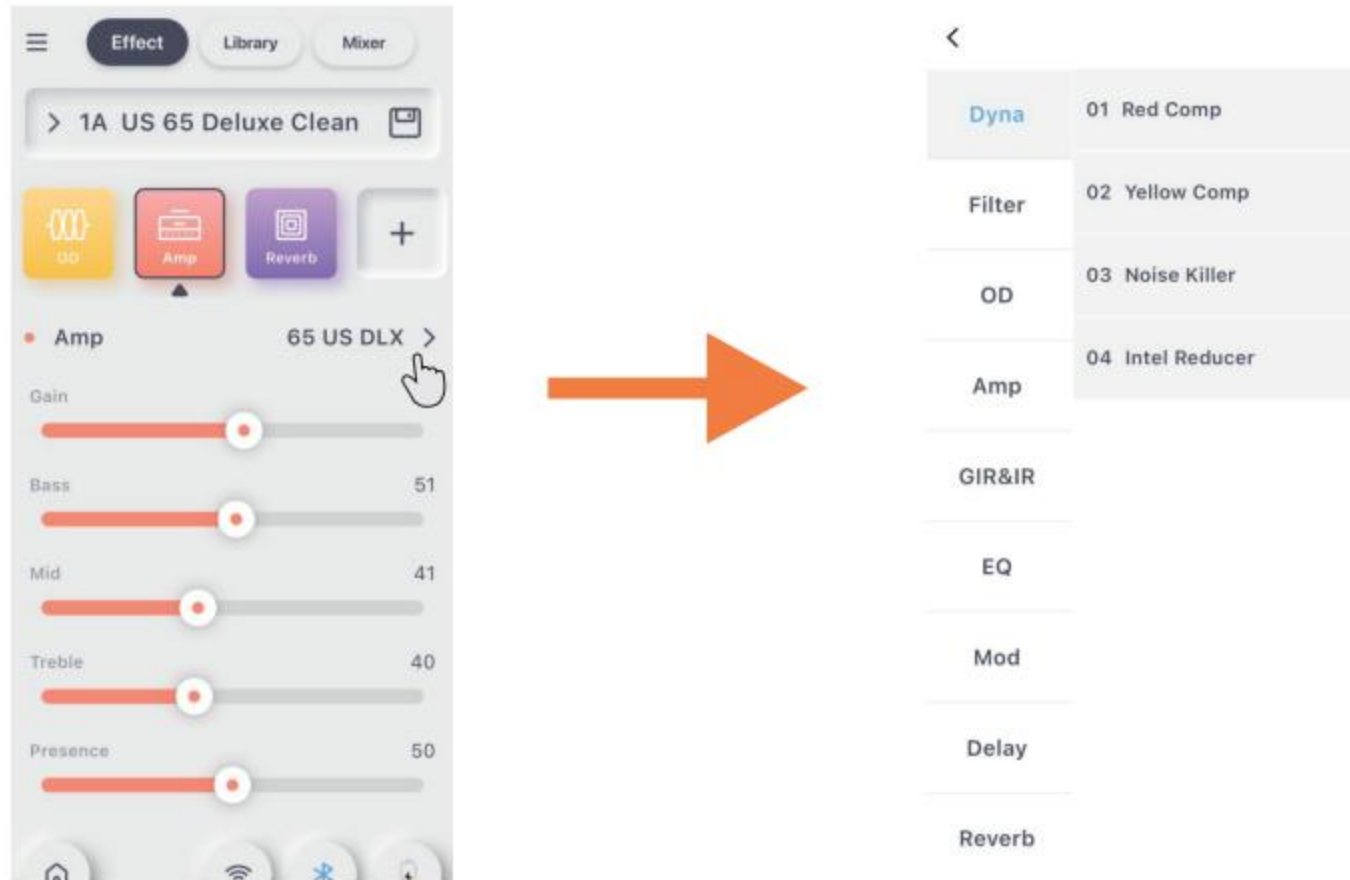

In the effect chain interface, click the model switch arrow to open the model list, where you can change to the desired effect model. In the parameter area, select a parameter and drag the slider left or right to adjust the selected parameter.

Save

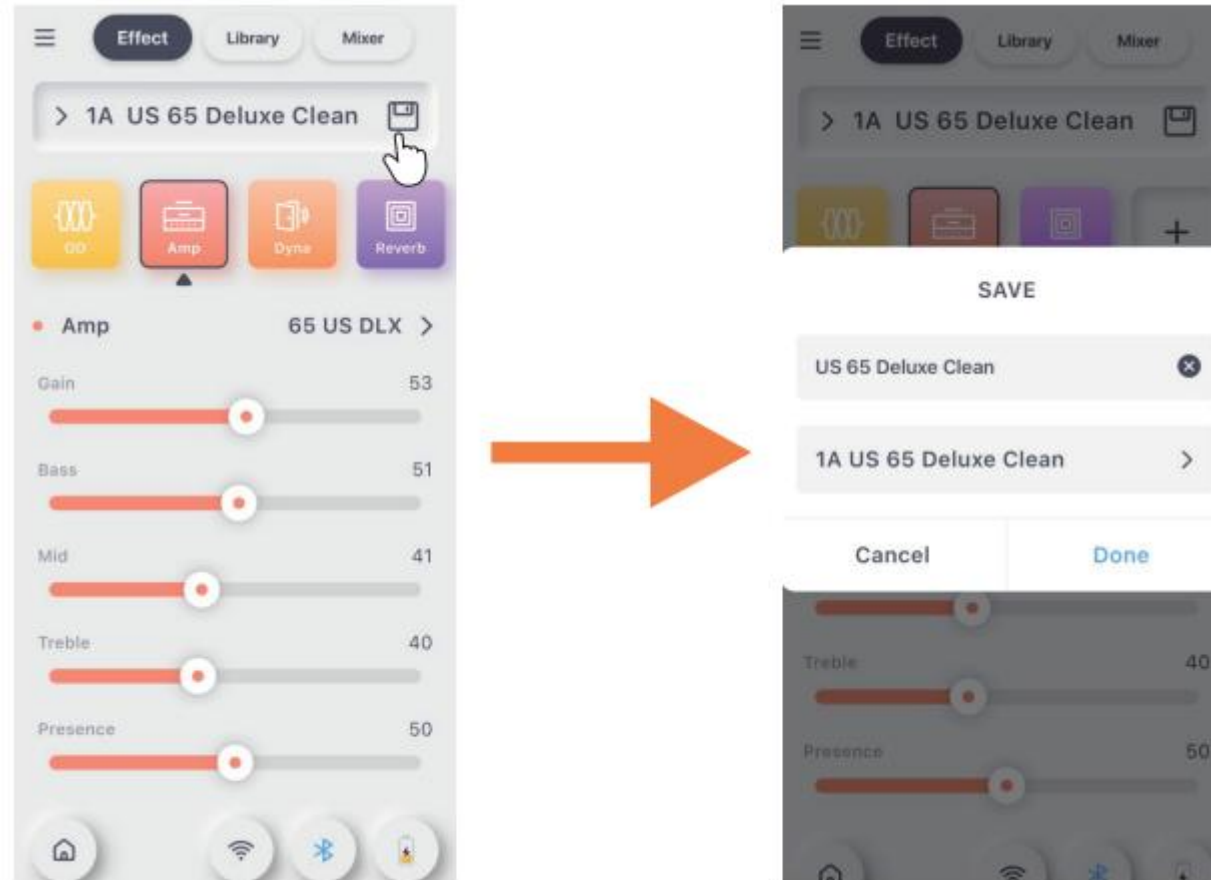

In the effect chain interface, click the save icon to open a confirmation dialog. In this dialog, you can modify the preset name, choose the preset location, and click 'Done' to successfully save.

BOTTOM STATUS BAR



Click the **'HOME'** icon to return to the home page.

Click the **QR code** icon to enter the serial number QR code scanning interface.

Click the wireless icon to enable **wireless footswitch** pairing mode on the F15i Li.

Click the **Bluetooth** icon to toggle Bluetooth on or off.

The **battery status** icon will display the current battery level of the device.

LIBRARY

After clicking the 'Sound Library' icon in the top status bar, you will enter the sound library interface. In the sound library, we have prepared 6 styles with a total of 30 sounds for you to choose from. You can select your favorite sound and save it to the F15i Li by clicking the save icon at the bottom of this interface.

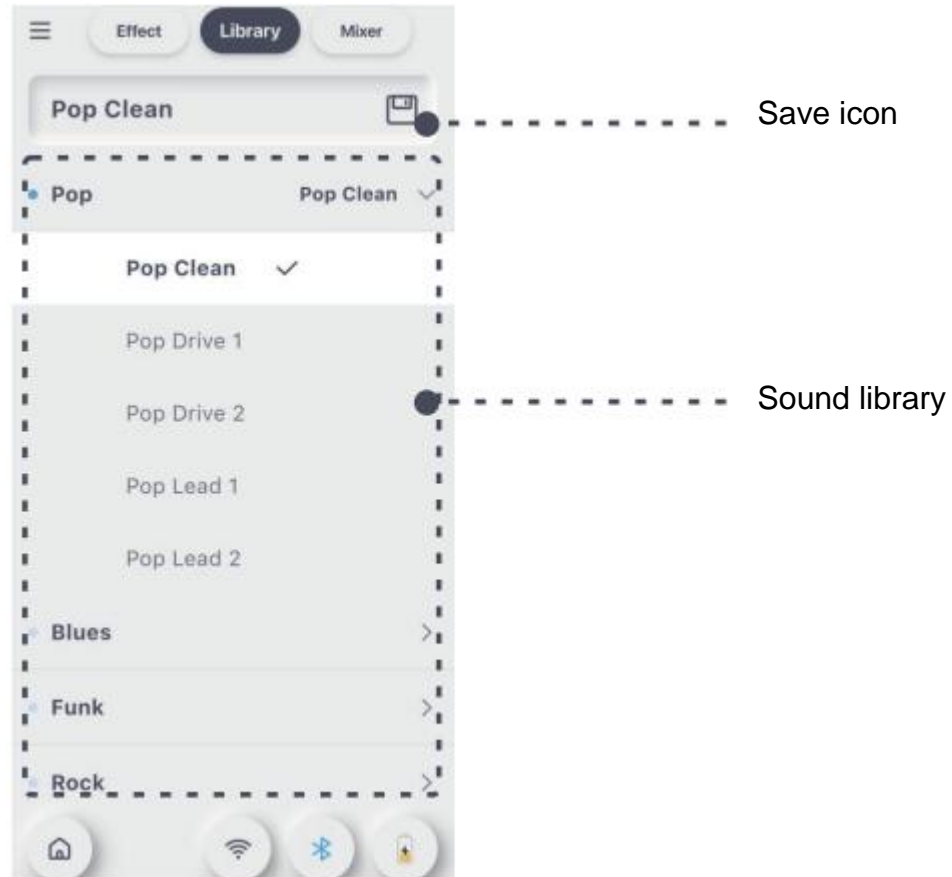

MIXER

After clicking the 'Mixer' icon in the top status bar, you will enter the mixer interface. In the mixer interface, you can adjust the volume of the three input sources: 'Bluetooth,' 'USB,' and 'Instrument.' You can also adjust the overall output volume in the 'Master Volume' section.

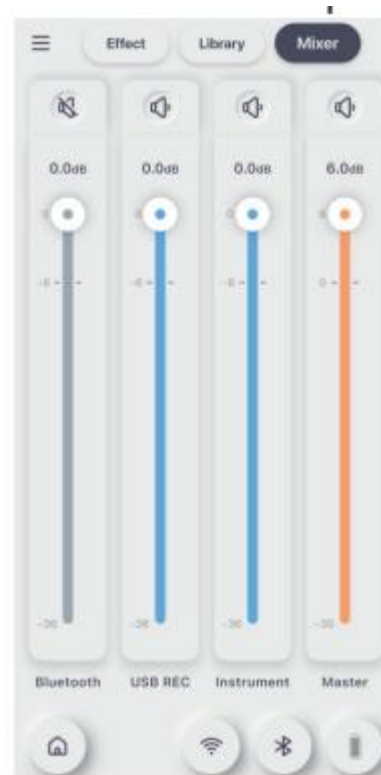

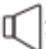
At the top of the adjustment section, you can toggle the volume of this channel by clicking the icon. When turned off, the volume slider area will turn gray, indicating that the channel is muted. 

(The volume adjustment range is: -36dB to 0dB, with the default setting at -6dB.)

MENU SIDEBAR OPTIONS

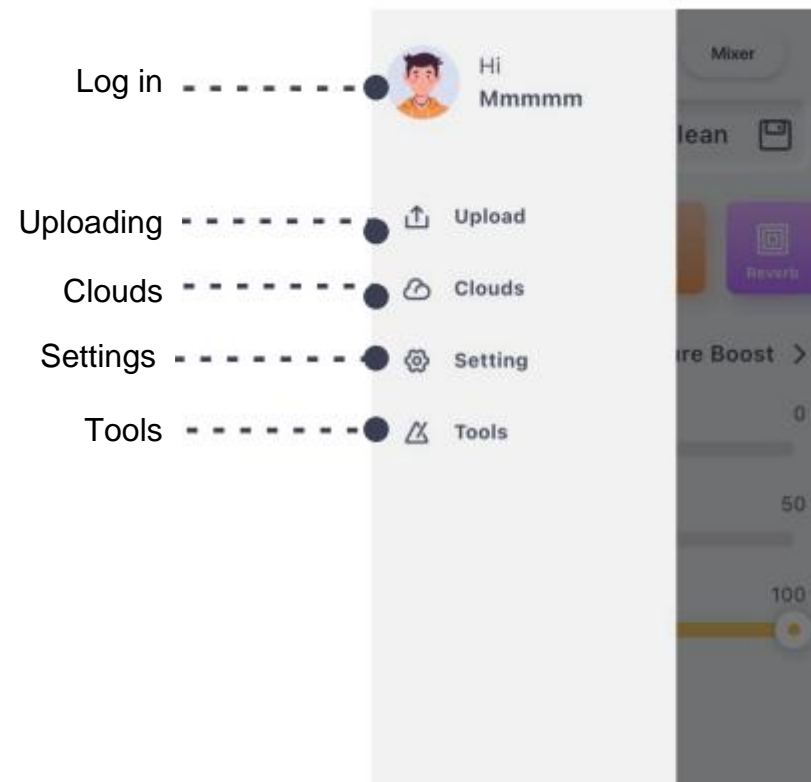

LOGIN

When not logged in, click this login entry to open the login interface. After entering your account and password, you can log in successfully. (If you don't have an account or have forgotten your password, you can register an account or recover your password through this interface.)

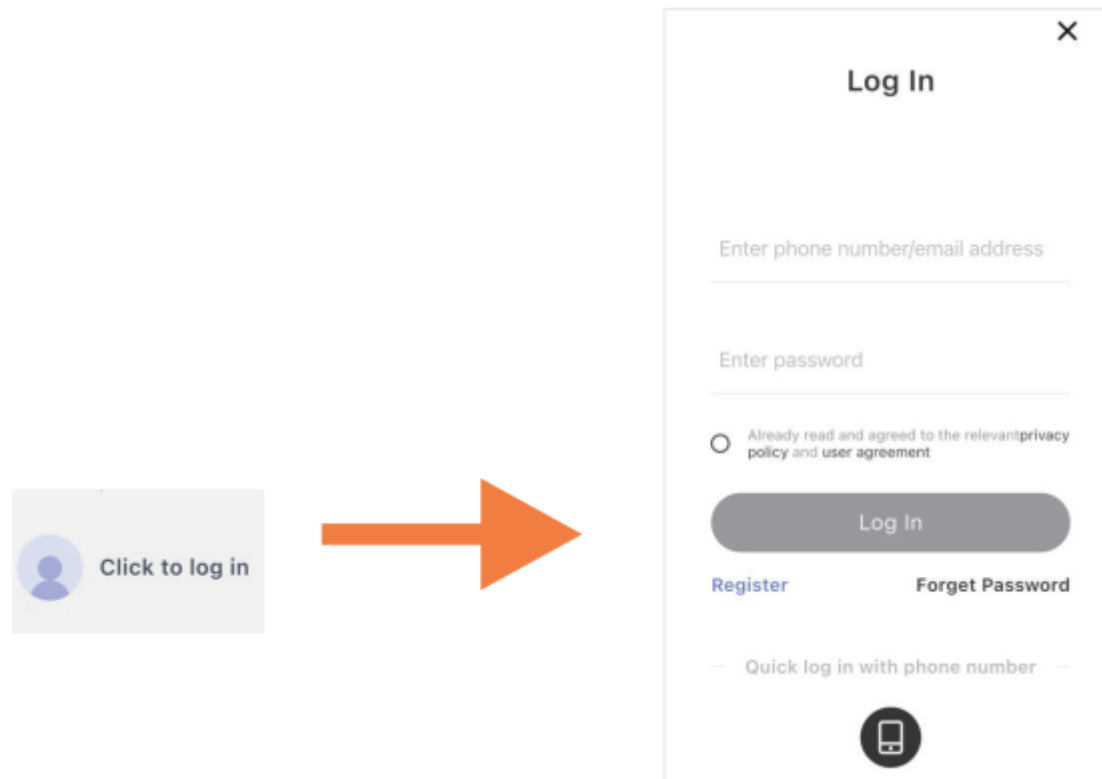

When logged in, click this login entry to view the list of presets you have currently uploaded and downloaded.

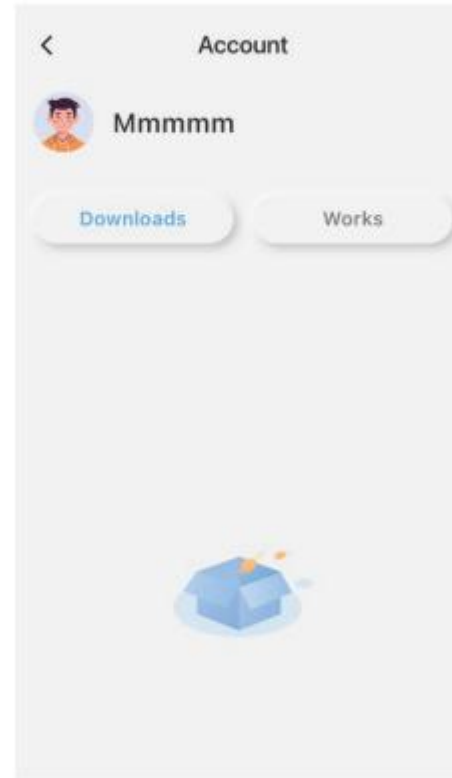
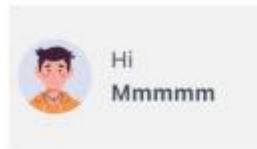

UPLOAD

Click the "Upload" icon in the menu sidebar to open the upload confirmation interface. In this interface, you can modify the preset name, description, and type. After clicking "Done," a successful upload prompt will appear, and you will be able to see the preset you just uploaded in the Sound Cloud. (Please note: Upload operations and accessing the Sound Cloud require you to be logged in.)

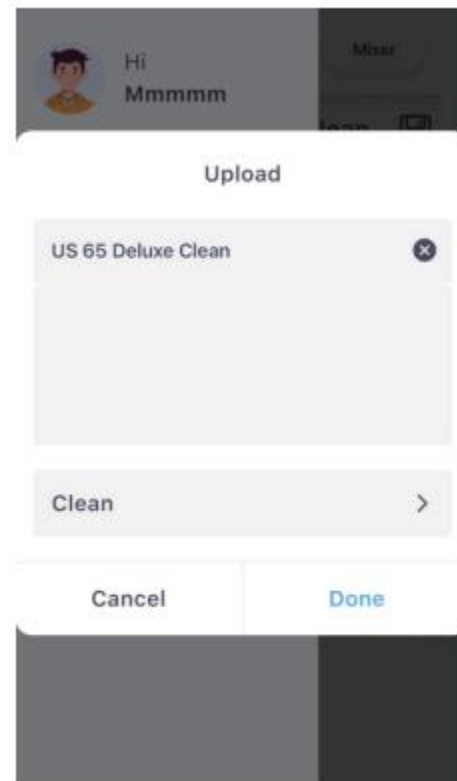

Sound Cloud

Click the "Sound Cloud" icon in the menu sidebar to enter the Sound Cloud. In the next interface, you can choose either "MNRS" or "PRESET." Clicking on these will take you to the sample cloud list or the preset cloud list, respectively.

Sample Cloud list

In the MNRS sample cloud list, you can find a vast collection of GNR & GIR (amp and cabinet sampling files) data. Find the sample file you need and click the download icon on the right to download it to the F15i Li.

The downloaded GNR files can be found at the bottom of the "Amp" module in the effect module list, while GIR files can be found within the "GIR & IR" module in the effect module list. (The F15i Li supports loading up to ten GNR files and ten GIR & IR files. For information on importing IR files, please refer to the "MOOER STUDIO FOR F15i Li" section below.)

Preset Cloud list

In the preset cloud list, you can browse and download presets shared by other users. Click on "Clean," "Low Gain," or "High Gain" at the top to categorize the presets within the list. The color block in front of each preset also indicates the type of preset. (Purple for clean, blue for low gain, orange for high gain).

Click the small headphone icon in front of a preset to preview the cloud preset.

Settings

Click  **Setting** in the sidebar to enter the settings interface. The following sections will provide a detailed introduction to each setting.



The screenshot shows the 'Setting' interface with the following callouts:

- Input gain**: Points to the 'Input Gain' section, which includes a 'Gain' slider set to 0 dB.
- Global bypass**: Points to the 'Global bypass' toggle switch, which is currently turned off.
- Stereo enhancement**: Points to the 'Virtual space' toggle switch, which is currently turned on.
- Song info**: Points to the 'Lyric display' toggle switch, which is currently turned on.
- Global EQ**: Points to the 'Global EQ' section, which includes a 'Global EQ' toggle switch (turned on) and four frequency sliders: 100 Hz (0.0 dB), 350 Hz (0.0 dB), 1800 Hz (0.0 dB), and 4000 Hz (-12.0 dB).
- Brightness**: Points to the 'Display Brightness' slider.
- Auto power off settings**: Points to the 'Auto Shutdown' dropdown menu, which is currently set to 'Never'.
- Ambient light**: Points to the 'Lighting' dropdown menu, which is currently set to 'Slow flashing'.
- Bluetooth rename**: Points to the 'Bluetooth rename' option.
- Version information**: Points to the 'Version' dropdown menu, which is currently set to 'V 1.1.0'.
- Restore to factory settings**: Points to the 'Reset' option at the bottom of the settings list.

Input Gain

The input gain for the 6.35mm instrument input can be adjusted. If you are using an instrument with a higher output power, you can set this to reduce clipping. (The adjustment range is from $-\infty$ to +6dB, with a default value of 0dB).

Global Bypass

When global bypass is enabled, the F15i Li can be used as a clean amp (without effects). At this point, all the tone models within the F15i Li will be bypassed, and a "Global Bypass" pop-up will appear in the effects chain interface.

Stereo Enhancement

In the F15i Li, using MOOER's latest algorithm, we provide a stereo surround enhancement effect. By turning on the "Virtual Space" switch in the settings, the sound coming from the speakers will become more three-dimensional and surround, offering a better sense of immersion.

Song Info Display

When this setting is enabled, the amp will show the song info display during Bluetooth music playback. In this interface, you can view information about the song that is currently played and perform actions such as pause, previous/next track, etc.

Global Equalizer

This setting allows you to adjust the equalization of four preset frequency points. These adjustments will directly affect the instrument's output, completely independent of any other presets.

Display Brightness

The display brightness setting allows you to adjust the brightness of the round screen on the device.

Auto Power Off

The F15i Li features an energy-saving mode. When the device remains idle (no input) for the duration set in this option, it will automatically shut down to reduce battery wear. Press and hold the power button again to turn it back on. (The default setting for this option is "Never").

Ambient Light

You can set the color and mode of the ambient light strip on the F15i Li.

- When "**Off**" is selected, the ambient light will turn off.
- When "**Static**" is selected, the ambient light will stay on in the color you choose (only one color).
- When "**Dynamic**" is selected, the ambient light will alternate in a breathing effect with the colors you select (multiple colors).

Bluetooth Renaming

By clicking on "Bluetooth Renaming," the Bluetooth naming interface will pop up. You can enter characters to customize the Bluetooth name of the device (as shown in the Bluetooth list of your mobile device). Click "OK" to save the new name.

Version

The firmware version is displayed in this area. You can click to check out the detailed information.

Reset

Should you experience any problems with your device, please try resetting it to factory settings first, before you contact customer service.

TOOLS

After clicking  on the sidebar, you will enter the tools interface. Within the tools interface, you can switch between functions using the three icons at the top: "Drum Kit," "Tuner," and "Loop Recording."

Drums

In the F15i Li, we provide 6 styles with a total of 60 drum kit patterns, along with 10 commonly used metronome patterns.

You can select from these 70 different patterns by clicking the rhythm pattern selection box at the bottom.

The central tap area allows you to press and tap for rhythm, and rotating the BPM ring enables quick adjustment of the BPM. Additionally, you can fine-tune the BPM by clicking the left and right arrows.

Click the Play/Pause button below to toggle the drum machine on or off. You can adjust the volume by clicking the volume icon on the right side.



Tuner

When you enter the tuner in the iAmp app, the F15i Li will also sync and enter tuner mode.

In the tuner, you can confirm whether the note is in tune based on the indicator bar. The reference pitch adjustment area below allows you to adjust the reference pitch, with a range from 430 to 445Hz.

You can also select the tuner mode by clicking the mute icon, choosing between "Mute" (no sound) or "Bypass" (amp without effects).



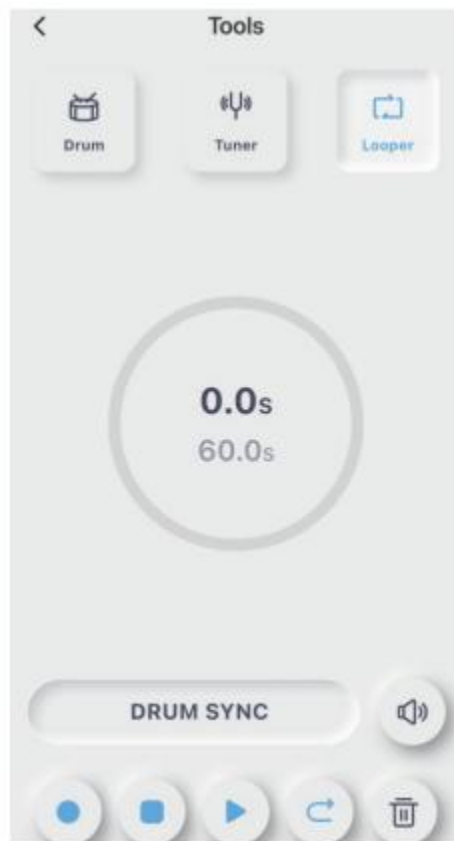

Loop Recording

In the F15i Li, we provide a stereo loop recorder with a total duration of 60 seconds. You can activate the loop recorder by selecting "Looper" in the tools interface of the iAmp app.





During recording, the circular display in the center of the interface will indicate the current recording duration, while the outer ring of the circle will show the current status of the loop recorder in color. Red indicates recording or overdubbing, and blue indicates playback.

Click the  icon to start recording or overdubbing. When recording/overdubbing, this icon will turn red to indicate the current status. (During the first recording when drum machine sync is not enabled, it will detect the input signal, and recording will only start once the input signal exceeds the set threshold.)

Click the  icon to pause during recording or playback. When paused, this icon will turn orange.

Click the  icon to start playback during recording or pause. When playing, this icon will turn green.

When the number of tracks is greater than or equal to 2, click the  icon to undo or redo. Undo will remove the last recorded track information, and redo will restore the removed track. (When the number of tracks is less than 2, this icon will be grayed out and not clickable.)

Click  to clear all current recorded information.

Click  to bring up the volume bar. Adjusting this bar will change the volume of the recorded information.

Drum Machine sync and alignment rules

By clicking the Drum Sync field in the loop recorder interface, you can enable drum machine sync for the loop recorder. Once this sync is enabled, clicking the record icon will play a one-bar preparatory beat at the current drum machine BPM before starting the recording. The recording process will follow the alignment rules between the drum machine and the loop recorder, ensuring that the audio you record is always in sync with the drum machine.

Alignment rules

- When the recording of the first audio ends before the halfway point of the current measure, the audio information from the current measure will be removed.
- When the recording of the first audio ends after the halfway point of the current measure, the recording will be extended to complete the current measure before ending.

MOOER STUDIO FOR FUTURE SERIES

Visit the MOOER official website at moeraudio.com, go to the Support area and find the F15i Li Download Section. Locate and download MOOER STUDIO FOR FUTURE SERIES.

In the PC software, you can perform firmware updates for the F15i Li, import third-party IR files, and back up or restore the entire device.

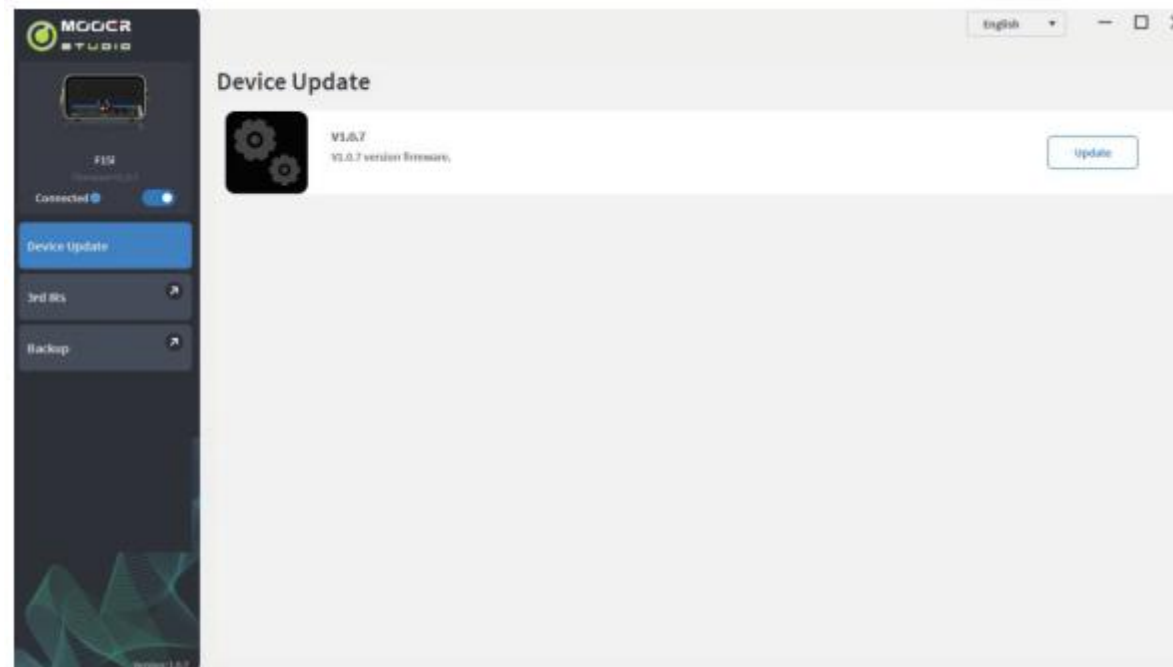

Firmware update

If the current firmware version does not match the software version, a prompt will appear for an update. Click "Update Firmware," and once the progress bar completes, the F15i Li will be successfully updated.

- Find the download section for your device on the MOOER website. Read the latest information for your update in the readme file. Download, install and start the software on your computer.
- Disconnect power from your device.
- Connect the included USB cable between device and computer first. Make sure to connect directly to a USB port on the computer. Do not run the connection through an USB hub.
- Connect power to your device and start your device.
- Open the software and click the connection switch to connect to your device. If the current firmware version does not match the software version, a prompt will appear for an update.
- Click "Update Firmware," and once the progress bar completes, the F15i Li will be successfully updated.

WARNING: Do not disconnect the USB or power supply connection during the update!

- Your device will automatically restart and a prompt in the software will notify you when the update is complete. Only then can you disconnect your device.
- Some firmware updates may delete custom presets. So please perform a backup of your presets before you attempt a firmware update. You can restore your presets after the update was performed successfully.

Note: To ensure a stable connection, avoid connecting through USB hubs and connect your USB cable directly to a port on your computer

Importing third-party IR files

After successful connection, click "Third-Party IRs" in the left sidebar of the editing software to enter the third-party IR file management interface. Choose the location where you want to import the file, and click the "+" icon on the right side to import the file. To delete an IR file loaded at a specific location, click the "-" icon on the right.

Full device backup and restore

Before performing a firmware update, it is recommended to back up the entire device to prevent the loss of tone files and settings. After successfully connecting, click "Backup" in the left sidebar of the editing software to enter the backup/restore interface. On the right side of this interface, click "Backup" to create a backup file. You can manage restores and deletions in the file management area at the bottom.

EFFECT DESCRIPTIONS

Dynamic		
No	Name	Tone Description
1	Red Comp	Dual-Parameter Adjustable Compressor
2	Yellow Comp	Based on the Mooer® YELLOW COMP compressor, it offers four adjustable parameters.
3	Noise Gate	Based on the Mooer® Micro Noise Killer. This unit quickly and effectively solves noise problems through simple threshold adjustment.
4	Intelligent Noise Gate	Unlike conventional noise gates, its principle separates the regular signal from the white noise, then eliminates the white noise. This reduces noise while maintaining the natural decay of the tail end. It is recommended to use this module before distortion effects or amp simulations.

Filter		
No.	Name	Tone Description
1	Touch Wah	Dynamic response auto wah with an envelope filter.
2	Auto Wah	Analog wah with an automatic frequency sweep function.
3	Filter	Modulated filter effect.

AMP		
No.	Name	Tone Description
1	MOOER® Pure Boost	Based on MOOER® Pure Boost
2	MOOER® Flex Boost	Based on MOOER® Flex Boost
3	B.K. Butler® Tubedrive	Based on B.K. Butler® Tube drive
4	IBANEZ® TS808	Based on IBANEZ® TS808 overdrive
5	Klon® Centaur Gold	Based on Klon® Centaur Gold overdrive
6	Barber® Direct Drive	Based on Barber® Direct Drive overdrive
7	Paul Cochrane® Timmy OD	Based on Paul Cochrane® Timmy OD overdrive
8	Fulltone® Fulldrive 2	Based on Fulltone® Fulldrive 2 overdrive
9	Xotic® BB Preamp	Based on Xotic® BB Preamp overdrive
10	Xotic® BB Plus	Based on Xotic® BB Plus overdrive
11	ProCo® Rat	Based on ProCo® Rat distortion
12	MOOER® Grey Faze	Based on MOOER® Grey Faze fuzz
13	EHX® Big Muff	Based on EHX® Big Muff fuzz
14	Fulltone® GT-500	Based on Fulltone® GT-500 distortion
15	Marshall® Shred Master	Based on Marshall® Shred Master distortion
16	Suhr® Riot	Based on Suhr® Riot distortion
17	BOSS® Metal Zone	Based on BOSS® Metal Zone distortion
18	Digitech® Metal Master	Based on Digitech® Metal Master distortion
19	Fulltone® OCD	Based on Fulltone® OCD distortion
20	NOBELS® ODR-1	Based on NOBELS® ODR-1 overdrive
21	FRIEDMAN® BE-OD	Based on FRIEDMAN® BE-OD distortion
22	MOOER® Solo	Based on MOOER® Solo distortion

PREAMP		
No.	Name	Tone Description
1	Fender® 65 Deluxe Reverb	Based on Fender® 65 Deluxe Reverb preamp
2	Fender® 65 Twin Reverb	Based on Fender® 65 Twin Reverb preamp
3	Fender® 59 Bassman	Based on Fender® 59 Bassman preamp
4	Fender® Super Sonic	Based on Fender® Super Sonic preamp
5	Fender® Blues Deluxe Clean	Based on Fender® Blues Deluxe preamp
6	Fender® Blues Deluxe Overdrive	Based on Fender® Blues Deluxe preamp
7	ENGL® E650 Clean	Based on ENGL® E650 preamp
8	ENGL® Powerball E645 CL	Based on ENGL® Powerball E645 preamp
9	ENGL® Blackmor CL	Based on ENGL® Blackmore preamp
10	MESA Boogie® MARK III CL	Based on MESA Boogie® MARK III preamp
11	MESA Boogie® MARK III CL	Based on MESA Boogie® MARK V preamp
12	MESA Boogie® Triple Rectifier CL	Based on MESA Boogie® Triple Rectifier preamp
13	Orange® Rockerverb CL	Based on Orange® Rockerverb preamp
14	DR.Z® Maz18 Jr	Based on DR.Z® Maz18 Jr preamp
15	DR.Z® Z-Wreck	Based on DR.Z® Z-Wreck preamp
16	Jet City® JCA100H CL	Based on Jet City® JCA100H preamp
17	Roland® JC-120	Based on Roland® JC-120 preamp
18	VOX® AC30 CL	Based on VOX® AC30 preamp
19	VOX® AC30 OD	Based on VOX® AC30 preamp
20	Hiwatt® DR-103	Based on Hiwatt® DR-103preamp
21	Peavey® 5150	Based on Peavey® 5150 preamp
22	Tone King® Falcon CL	Based on Tone King® Falcon preamp
23	Tone King® Falcon OD	Based on Tone King® Falcon preamp
24	Two Rock® Cora CL	Based on Two Rock® Coral preamp
25	Two Rock® Cardiff	Based on Two Rock® Cardiff preamp
26	E VH® 5150 CL	Based on EVH® 5150 preamp
27	Blackstar® HT Stage 100 CL	Based on Blackstar® HT Stage 100 preamp
28	Diezel® Hagen CL	Based on Diezel® Hagen preamp
29	Koch® Powertone OD	Based on Koch® Powertone preamp
30	Marshall® JCM800	Based on Marshall® JCM800 preamp
31	Marshall® JCM900	Based on Marshall® JCM900 preamp
32	Marshall® Plexi 100	Based on Marshall® Plexi 100 preamp
33	Engl® E650 DS	Based on Engl® E650 preamp
34	ENGL® Powerball E645 DS	Based on ENGL® Powerball E645preamp

35	ENGL® Blackmore DS	Based on ENGL® Blackmore preamp
36	MESA Boogie® MARK III DS	Based on MESA Boogie® MARK III preamp
37	MESA Boogie® MARK V DS	Based on MESA Boogie® MARK V preamp
38	MESA Boogie® Triple Rectifier DS	Based on MESA Boogie® Triple Rectifier preamp
39	Orange® Rockverb DS	Based on Orange® Rockverb preamp
40	Orange® AD30	Based on Orange® AD30 preamp
41	Orange® OR50	Based on Orange® OR50 preamp
42	Soldano® SLO-100 OD	Based on Soldano® SLO-100 preamp
43	Soldano® SLO-100 DS	Based on Soldano® SLO-100 preamp
44	Jet City® JCA100H OD	Based on Jet City® JCA100H preamp
45	Peavey® 5150 DS	Based on Peavey® 5150 preamp
46	Tone King® Falcon OD	Based on Tone King® Falcon preamp
47	Two Rock® Coral OD	Based on Two Rock® Coral preamp
48	E VH® 5150 DS	Based on EVH® 5150 preamp
49	Blackstar® HT Stage 100 DS	Based on Blackstar® HT Stage 100 preamp
50	Diezel® Hagen OD	Based on Diezel® Hagen preamp
51	Diezel® Hagen DS	Based on Diezel® Hagen preamp
52	Koch® Powertone DS	Based on Koch® Powertone preamp
53	Markbass® R50	Based on Markbass® R500 preamp
54	Ampeg® SVT 4 Pr	Based on Ampeg® SVT 4 Pro preamp
55	Aguilar® DB750CL	Based on Aguilar® DB750 preamp

EQ		
No.	Name	Tone Description
1	5-Band Equalizer	5-band equalizer effect for guitar.
2	Custom Equalizer	Provides a 4-band equalizer effect with customizable frequency points.

Modulation		
No.	Name	Tone Description
1	Classic Phaser	Based on MOOER® Ninety Orange
2	Wave Phaser	Based on Square Wave Phaser Effect.
3	Classic Flanging	Based on MOOER® E-Lady
4	Jet Flanging	Based on MOOER® Jet Flanger
5	Tremolo	Based on MOOER® Trelicopter
6	Wave Tremolo	Based on square wave modulation for volume tremolo effects.
7	Pitch Tremolo	Standard pitch modulation tremolo effect.
8	Rotary	Simulates the classic rotary speaker sound.
9	Ring Mod	A modulation effect that combines signals to create metallic, bell-like tones.
10	Harmonic Transposition	A transposition effect that supports multiple notes being played simultaneously.
11	Analog Chorus	A classic, rich analog chorus sound.
12	Triple Chorus	A chorus effect that applies three layers for a fuller sound.
13	Lo-Fi	Achieved by lowering the sample rate to create a lo-fi tone.
14	Slow Attack	A slow attack effect that weakens or removes the initial transient sound.
15	Panning	Creates a stereo effect by moving the sound across the left and right channels.
16	Pitch Shift	Based on the original pitch with slight variations in pitch added for a distinctive effect.
17	Octave	Adds an octave above or below the dry signal, based on the original sound.

DELAY		
No.	Name	Tone Description
1	Digital	A basic digital delay effect where each repetition of the signal is clearly repeated.
2	Analog	Uses digital technology to recreate the warm and smooth characteristics of analog circuit delay.
3	Echo	Reproduces the echo sound of a real space.
4	Tape	Simulates the sound of classic tape delay.
5	Modulated	Adds modulation effects to the delay sound.
6	Reverse	Reverse playback delay effect.
7	Ping Pong	Highly spatial left-right ping pong delay.
8	Crystal Modulated	Increases the delay feedback by five octaves, creating a crystal-clear effect.
9	Rainbow Modulated	Raises each feedback delay effect by a certain interval, forming a dreamy, rainbow-like gorgeous effect.
10	Vintage	Includes some lo-fi delay effect in the delay sound, restoring a vintage tone.
11	Slow Attack	Includes slow attack delay effect in the delay sound, giving your music endless space for imagination.
12	Filtered	Includes a filter in the delay effect.

REVERB		
No.	Name	Tone Description
1	Room	Reproduces the reverb of a smaller space.
2	Hall	Reproduces the reverb of a larger space, with rich diffusion and a longer decay time.
3	Plate	A bright metallic plate reverb effect.
4	Spring	A retro spring reverb effect.
5	Modulated	Adds chorus to the reverb effect for a more detailed sound.
6	Starlight	A stunning reverb with Shimmer effect, creating a beautiful tone.
7	Flanged	Adds a flanging effect to the reverb, making the sound more psychedelic.
8	Reverse	Adds a reverse effect to the reverb, offering a completely different experience compared to traditional reverb.
9	Distorted	Adds distortion to the reverb, resulting in an extremely unnatural reverb effect.

Note: The brand names and product names mentioned in this manual are the property of their respective companies and are used here solely for the purpose of describing the effect tones simulated by this product.

TECHNICAL SPECIFICATIONS

	Item	Description
Effects	Number of modules	9
	Total number of models	more than 120
	Preset slots	80
Input	GUITAR IN	
	Interface type	1/4" unbalanced mono input
	Input impedance	1 MOhm
	Maximum input level	10 dBu
Output	OUTPUT	
	Interface type	2 x 1/4" unbalanced mono outputs
	Input impedance	600 Ohm
	Maximum output level	10 dBu
	PHONES	
	Interface Type	1/8" unbalanced stereo output
	Input Impedance	1 Ohm
	Maximum Output Level	5 dBu
	USB	

	Interface type	TYPE-C
	USB AUDIO	USB2.0, 2 in 2 out, 44.1~192 kHz, 24 bit
	CAB	
	Power	15W (2 x 7.5W) Class D Amplifier
	Size	2 x 2-inch custom full-range speakers
General	Power adapter specs	5V 2A
	Battery capacity & life	4000 mAH Approximately 6 hours of music playback or playing time (with app fader at 0 dB and master volume knob at 50%).
	Charging Time	Approximately 4.5 hours (5V 2A power supply)
	Dimensions	264*128*147mm (L x W x H)
	Weight	1.48 kg
	Accessories	USB cable, Quick Start Guide, handle strap

TROUBLESHOOTING

Cannot power on

- Ensure that the correct power adapter is connected (**5V 2A**).
- Make sure the battery has enough power to start, or try powering on after connecting the correct power adapter.
- Press and hold the power button for more than **2 seconds**.

No sound after powering on

- Make sure the '**MASTER**' volume knob on the panel is turned to an appropriate level.
- Open the **iAmp APP** and ensure the volume fader on the mixer is at a suitable position.
- In the **iAmp APP**, go to **{Settings}** and find the input gain fader, ensuring it is set to an appropriate level.
- Check all effect model parameters in the effect chain to see if the **{Volume}** parameter is set correctly.

Excessive background noise

- Use connection cables with good shielding performance.
- Change the usage environment or time to eliminate potential power interference.
- Try to stay away from computer cases, motors, fans, and other electrical devices to avoid electromagnetic interference.

The device does not work as expected

- Navigate to the SYSTEMS menu in the iAmp app and reset your device to factory settings. See [FACTORY RESET](#) above.
- Download the latest version of the MOOER Studio software on your computer, connect your device and perform a firmware update. See section [FIRMWARE UPDATE](#) above.



MOOER
www.moeraudio.com

SHENZHEN MOOER AUDIO CO., LTD.
5F Unit B Jinghang Building, Liuxian 3rd Road,
Bao'an 71 District, Shenzhen, China. 518133
Tel: +86-0755-2163-6506
Made in China